

PERFORMANCE CURVES

TNL 40-160
50 Hz - 1450 rpm

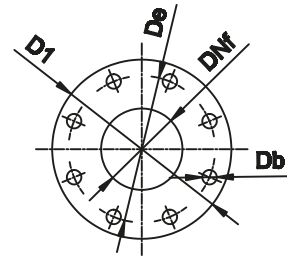

EN1092-1 PN16				
DNf	D1	De	Db	Qty.
40	150	110	18	4
40	150	110	18	4

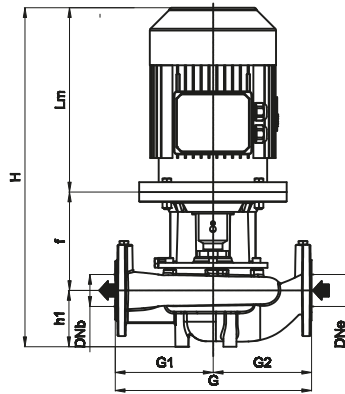
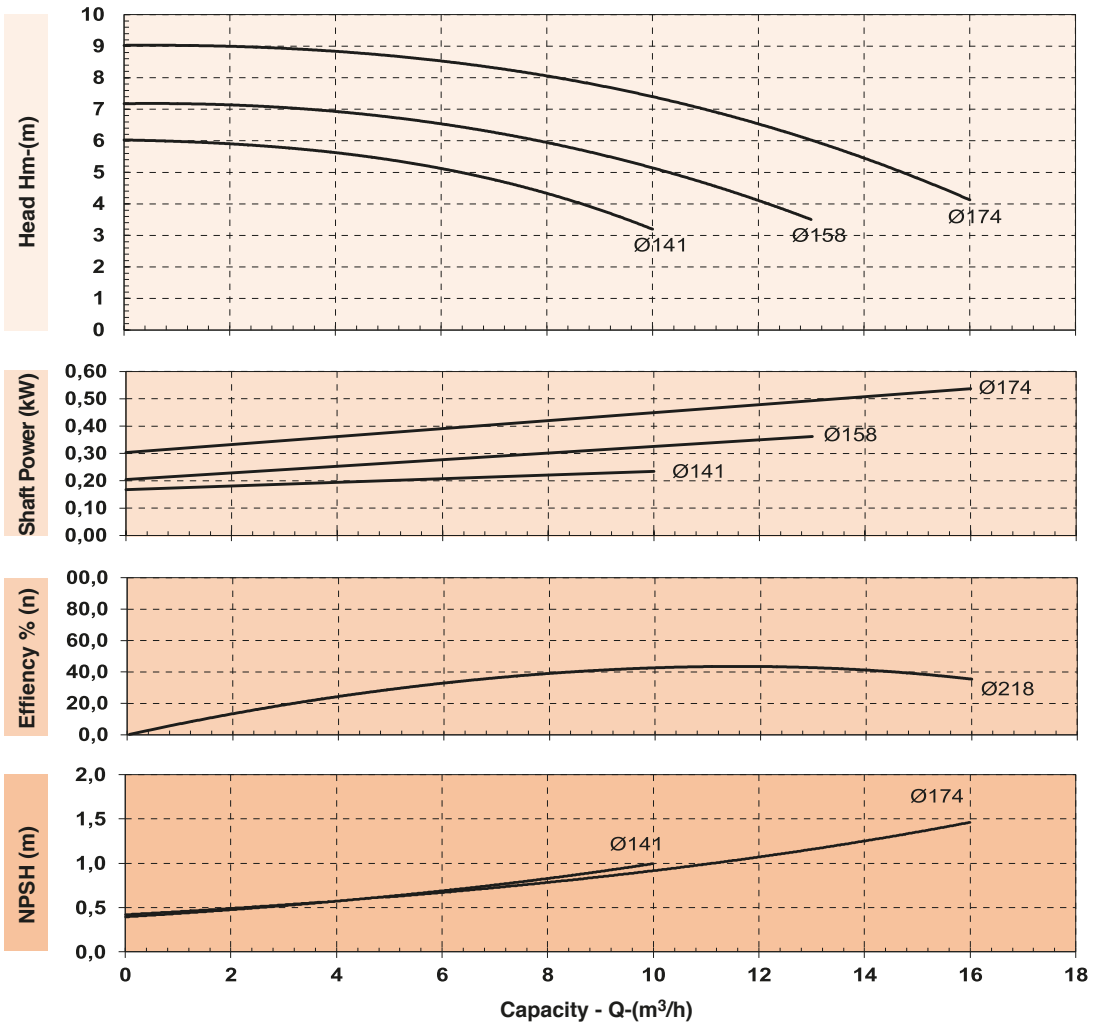

Pump Type	kW	DNb- DNe Outlet- Inlet	Dimension							Mec. Seal Diameter	Shaft and Coupling	Motor Padestal	Motor Flange	Weight (kg.)
			Lm	G	H	G2	G1	h1	f					
TNL 40-160	0,55	DN 40-	252,5		492					20	1A Mil	A1	-	35,6
	0,75	DN 40	283,5	320	523	160	160	80	160	20	1A Mil	A1	-	36,8



PERFORMANCE CURVES

TNL 40-200
50 Hz - 1450 rpm

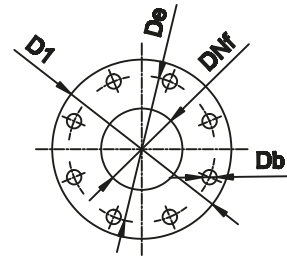
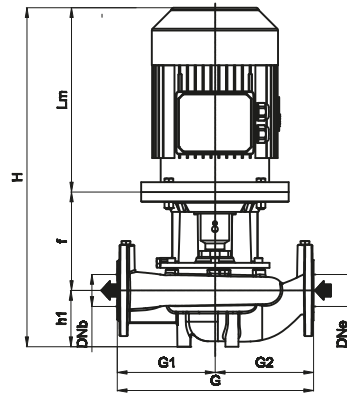

EN1092-1 PN16				
DNf	D1	De	Db	Qty.
40	150	110	18	4
40	150	110	18	4

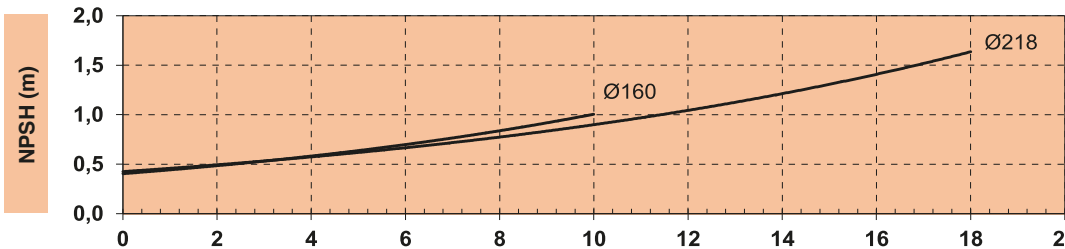
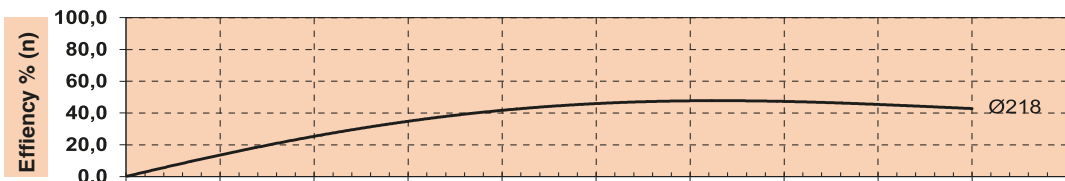
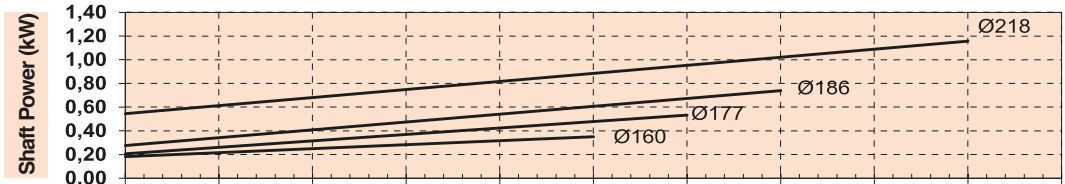
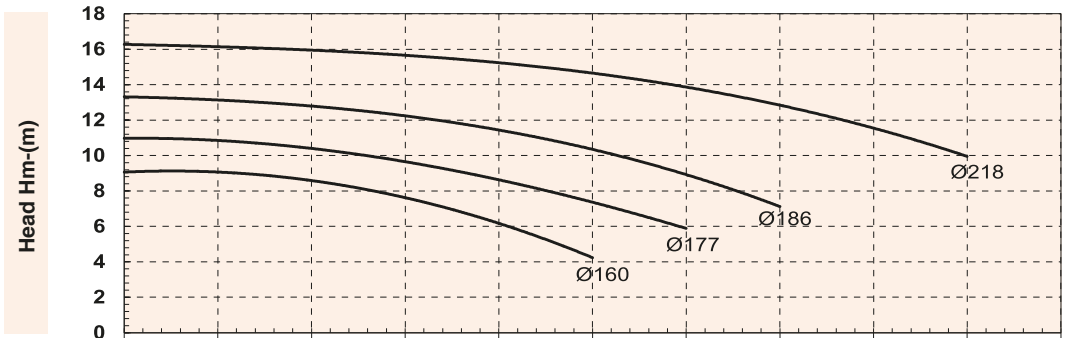

Capacity - Q-(m³/h)

Pump Type	kW	DNb- DNc Outlet- Inlet	Dimension							Mec. Seal Diameter	Shaft and Coupling	Motor Pedestal	Motor Flange	Weight (kg.)
			Lm	G	H	G2	G1	h1	f					
TNL 40-200	0,55	DN40- DN40	252,5		507,5				160	20	1A Mil	A2	-	40,1
	0,75		283,5	380	538,5	190	190	95	160	20	1A Mil	A2	-	41,2
	1,1		316,5		571,5				160	20	1B Mil	A2	-	44,7



PERFORMANCE CURVES

TNL 40-250
50 Hz - 1450 rpm

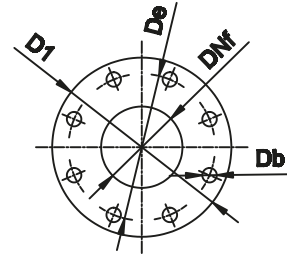
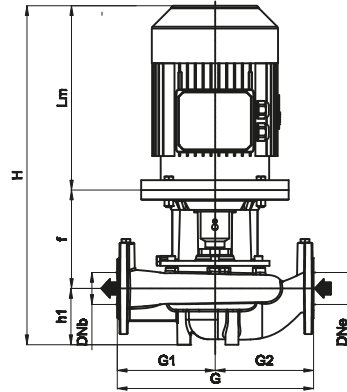

EN1092-1 PN16				
DNf	D1	De	Db	Qty.
40	150	110	18	4
40	150	110	18	4

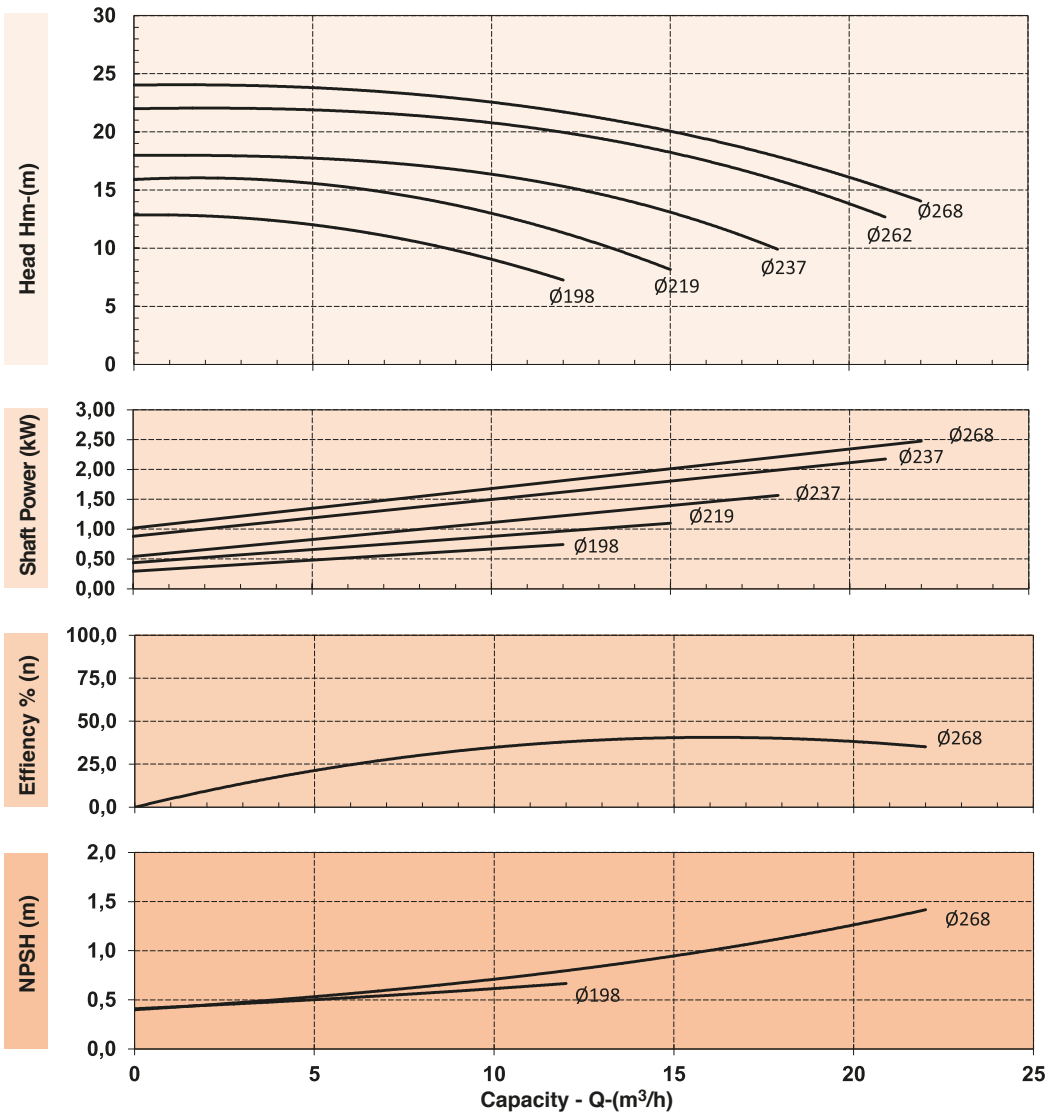

Pump Type	kW	DNb-DNe Outlet- Inlet	Dimension							Mec. Seal Diameter	Shaft and Coupling	Motor Padestal	Motor Flange	Weight (kg.)
			Lm	G	H	G2	G1	h1	f					
TNL 40- 250	0,75	DN 50 – DN 50	243,5	440	513,5	225	215	100	170	20	1A	A3	-	56
	1,1		266,5		533,5				170	20	1B	A3	-	60
	1,5		266,5		533,5				170	20	1B	A3	-	65
	2,2		292		580				190	20	1C	A3	-	70
	3		292		580				190	20	1C	A3	-	74



PERFORMANCE CURVES

TNL 50-160
50 Hz - 1450 rpm

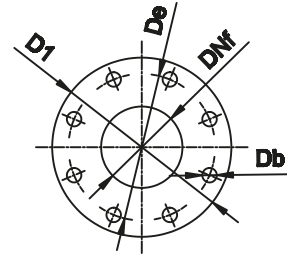
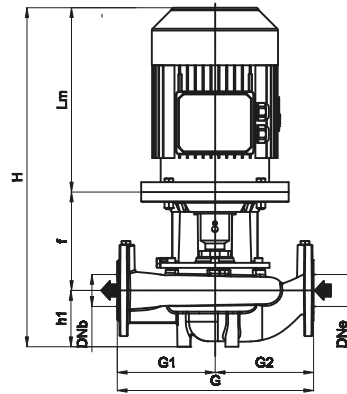

EN1092-1 PN16				
DNf	D1	De	Db	Qty.
50	165	125	18	4
50	165	125	18	4

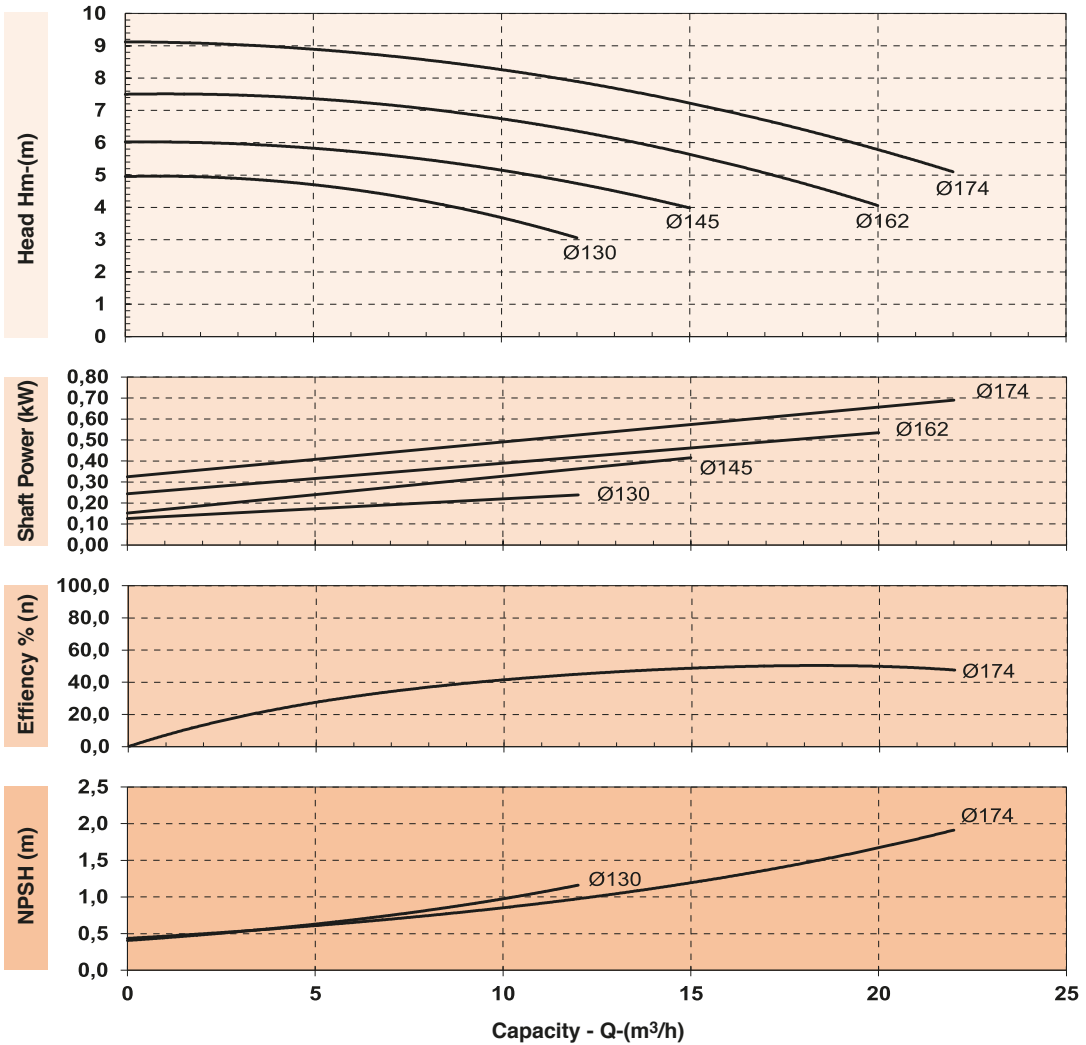

Pump Type	kW	DNb-DNe Outlet-Inlet	Dimension							Mec. Seal Diameter	Shaft and Coupling	Motor Pedestal	Motor Flange	Weight (kg.)
			Lm	G	H	G2	G1	h1	f					
TNL 50-160	0,55	DN50-DN50	252,5	360	512,5	180	180	100	160	20	1A Mil	A1	-	38,5
	0,75		283,5		543,5		160		1A MIL		-		39,6	
	1,1		316,5		576,5		160		1A MIL		-		41,6	



PERFORMANCE CURVES

TNL 50-200
50 Hz - 1450 rpm

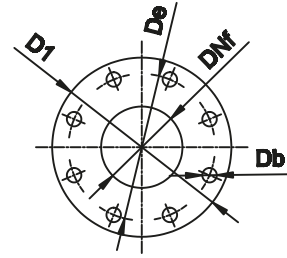
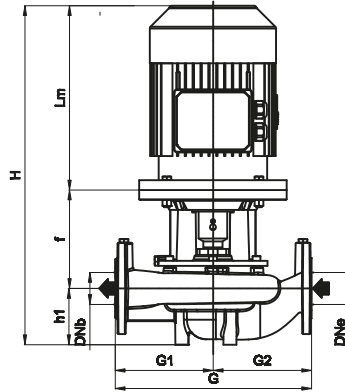

EN1092-1 PN16				
DNf	D1	De	Db	Qty.
50	165	125	18	4
50	165	125	18	4

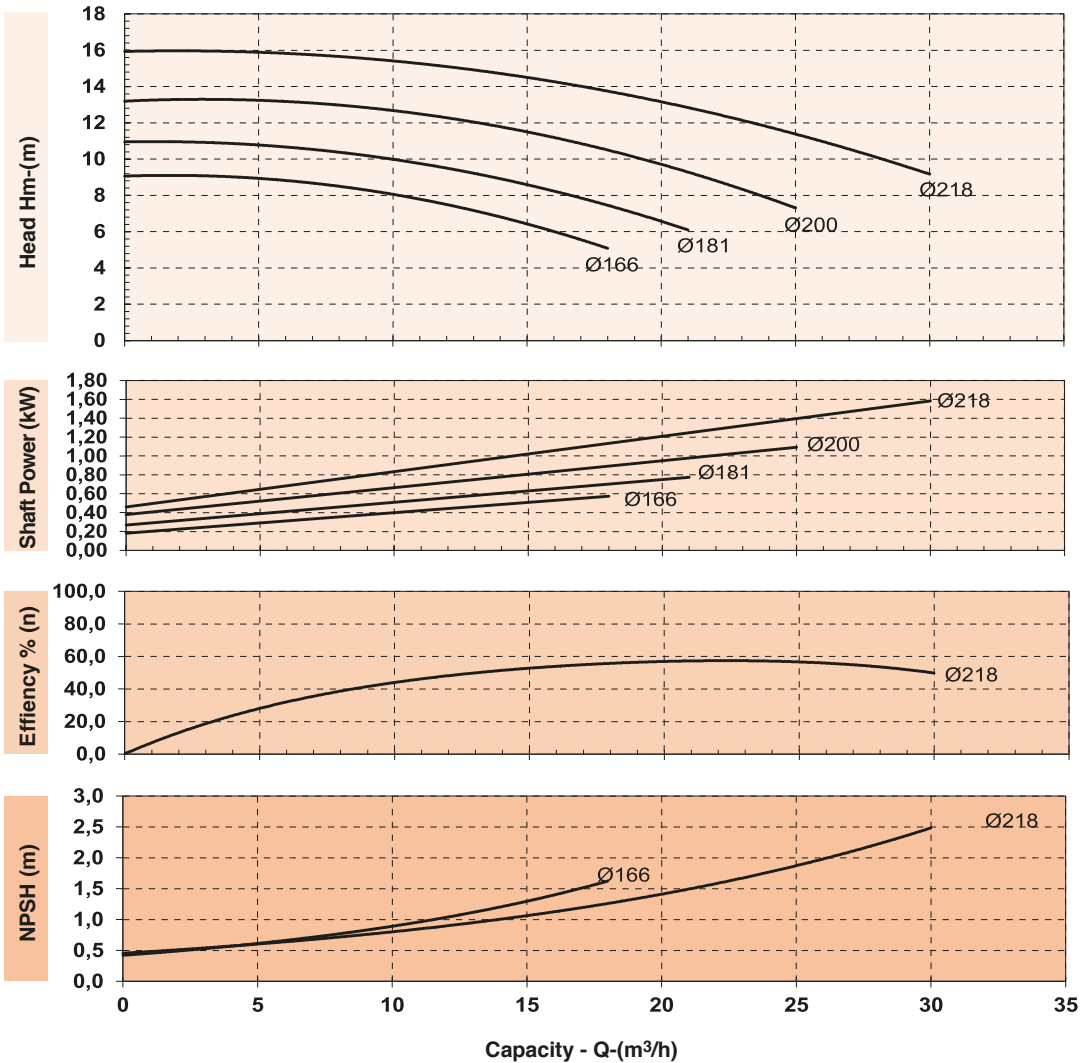

Pump Type	kW	DNb-DNe Outlet-Inlet	Dimension							Mec. Seal Diameter	Shaft and Coupling	Motor Pedestal	Motor Flange	Weight (kg.)
			Lm	G	H	G2	G1	h1	f					
TNL 50-200	0,55	DN50-DN50	252,5	400	522,5	200	200	110	160	20	1A MiL	A2	-	42,4
	0,75		283,5		553,5				160					
	1,1		316,5		586,5				160					
	1,5		316,5		586,5				160					



PERFORMANCE CURVES

TNL 50-250
50 Hz - 1450 rpm

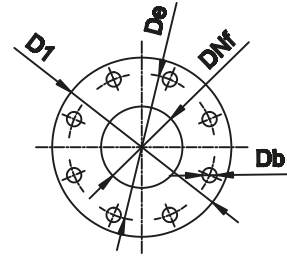
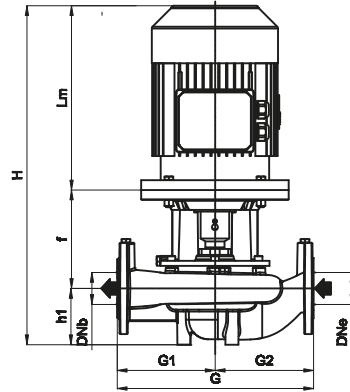

EN1092-1 PN16				
DNf	D1	De	Db	Qty.
50	165	125	18	4
50	165	125	18	4

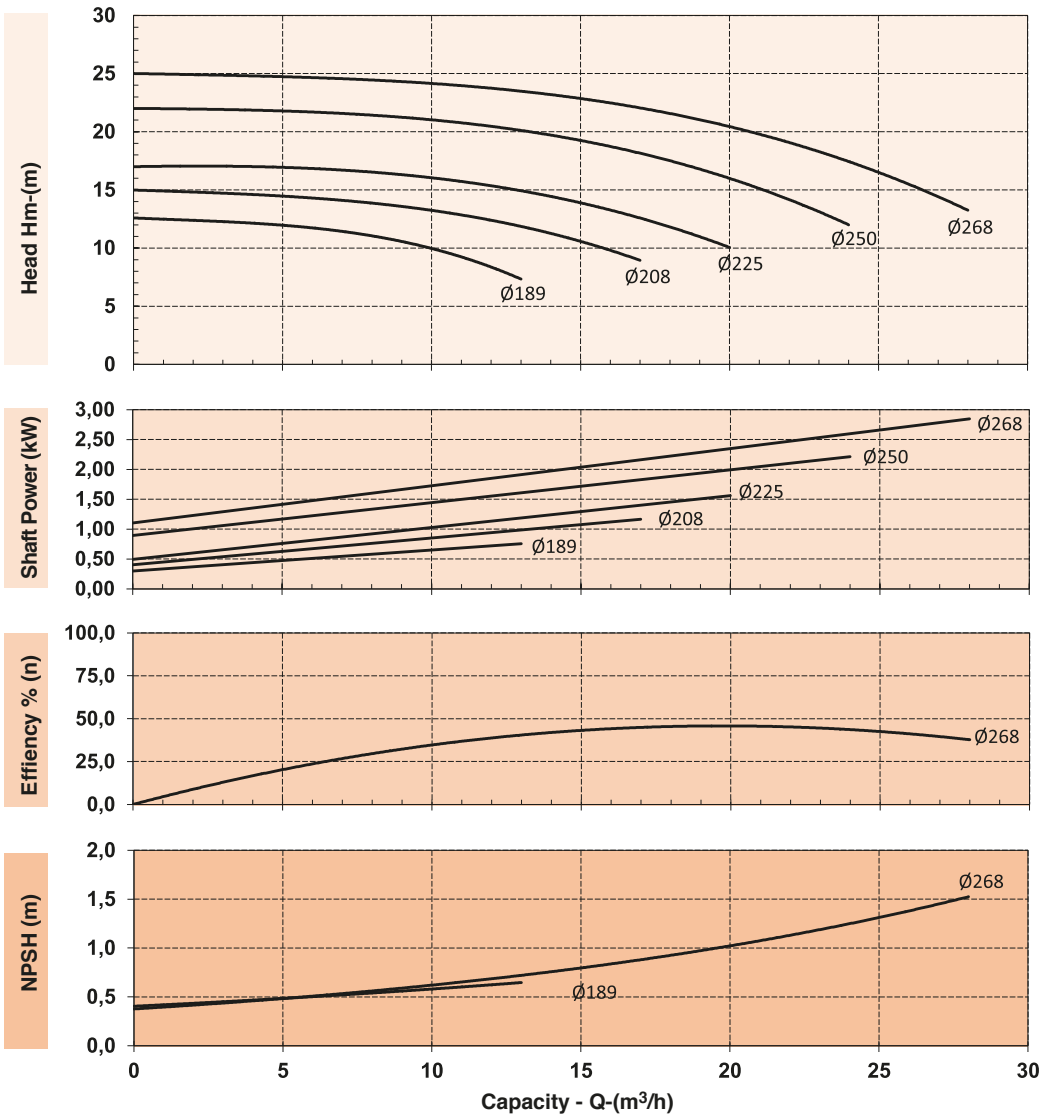

Pump Type	kW	DNb-DNe Outlet-Inlet	Dimension							Mec. Seal Diameter	Shaft and Coupling	Motor Padestal	Motor Flange	Weight (kg.)			
			Lm	G	H	G2	G1	h1	f								
TNL50-250	0,75	DN 50 – DN 50	243,5	440	518,5	225	215	115	160	20	1A	A3	-	60			
	1,1		266,5		541,5				160					20	1B	A3	65
	1,5		266,5		541,5				160					20	1B	A3	69
	2,2		292		587				180					20	1C	A3	71,3
	3		292		587				1890					20	1C	A3	75



PERFORMANCE CURVES

TNL 65-160
50 Hz - 1450 rpm

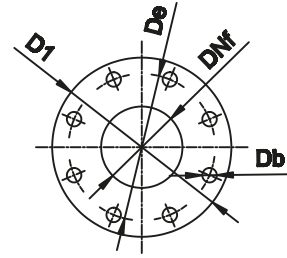
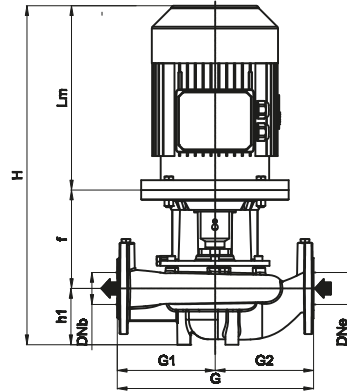

EN1092-1 PN16				
DNf	D1	De	Db	Qty.
65	185	145	18	4
65	185	145	18	4

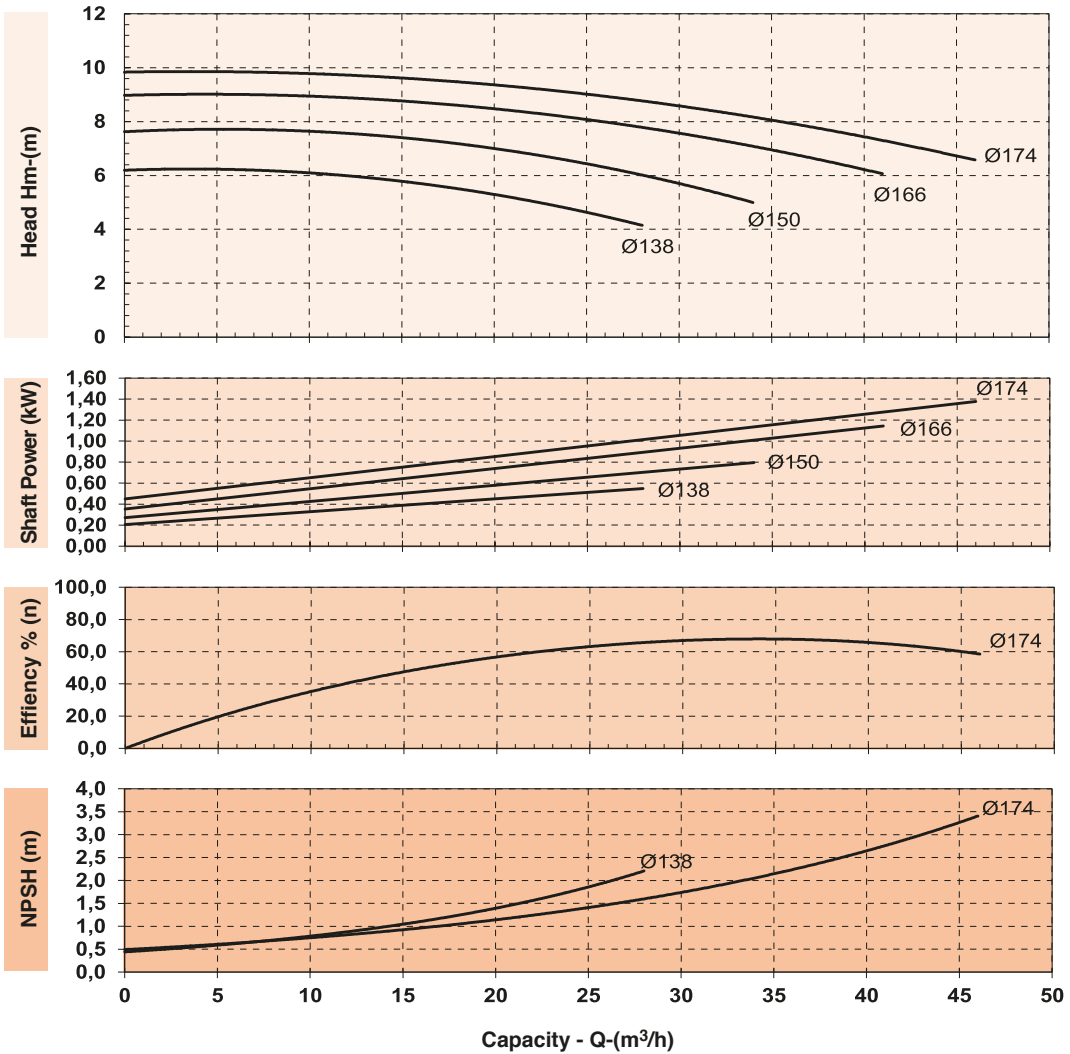

Pump Type	kW	DNb- DNe Outlet- Inlet	Dimension								Mec. Seal Diameter	Shaft and Coupling	Motor Padestal	Motor Flange	Weight (kg.)
			Lm	G	H	G2	G1	h1	f						
TNL 65- 160	0,75	DN65- DN65	283,5		558,5					160	20	1A MIL	A1	-	42
	1,1		316,5	400	591,5	200	200	115	160	20	1A MIL	A1	-	45,3	
	1,5		316,5		591,5					160	20	1B MIL	A1	-	46,5



PERFORMANCE CURVES

TNL 65-200
50 Hz - 1450 rpm

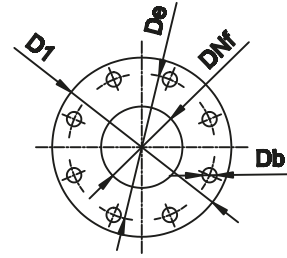
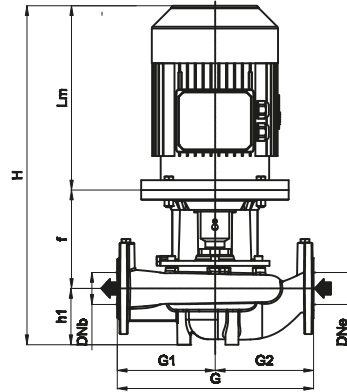

EN1092-1 PN16				
DNf	D1	De	Db	Qty.
65	185	145	18	4
65	185	145	18	4

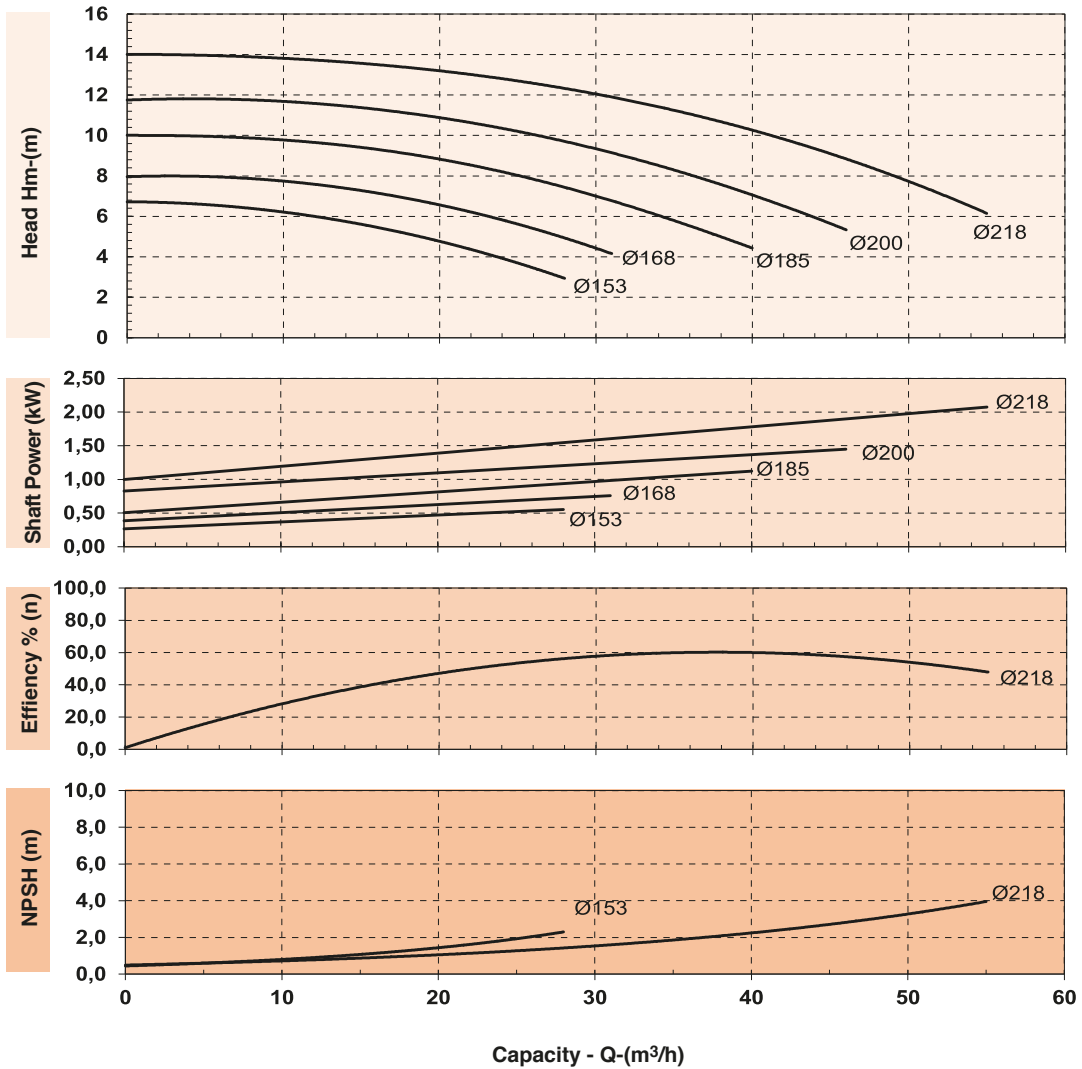

Pump Type	kW	DNb- DNe Outlet- Inlet	Dimension							Mec. Seal Diameter	Shaft and Coupling	Motor Padestal	Motor Flange	Weight (kg.)					
			Lm	G	H	G2	G1	h1	f										
TNL 65-200	1,1	DN65- DN65	316,5	460	591,5	230	230	115	160	20	1A MİL	A2	-	51,95					
	1,5		316,5		591,5				160						20	1B MİL	A2	-	52,88
	2,2		305		600				180						20	1B MİL	A2	-	63,2
	3		352		647				180						20	1C MİL	A2	-	63,2



PERFORMANCE CURVES

TNL 65-250
50 Hz - 1450 rpm

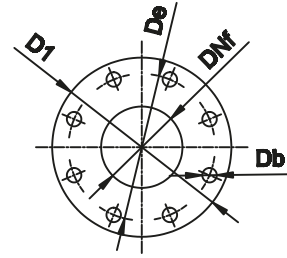
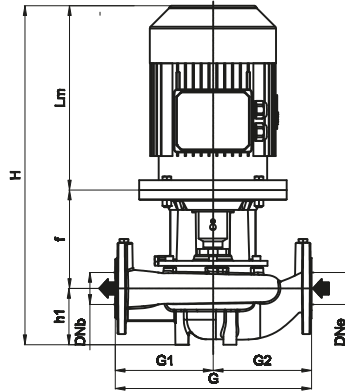

EN1092-1 PN16				
DNf	D1	De	Db	Qty.
65	185	145	18	4
65	185	145	18	4

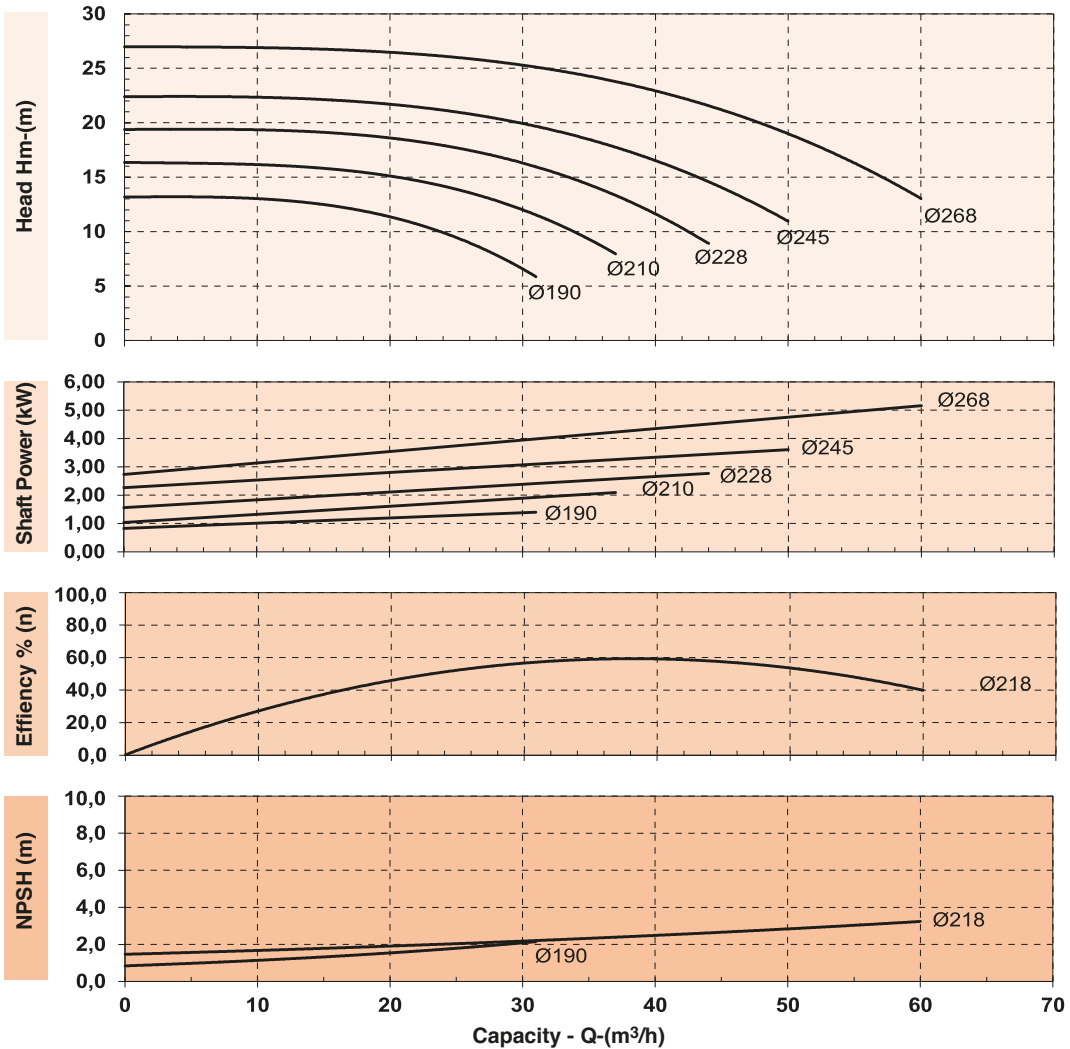

Pump Type	kW	DNb- DNe Outlet- Inlet	Dimension							Mec. Seal Diameter	Shaft and Coupling	Motor Padestal	Motor Flange	Weight (kg.)				
			Lm	G	H	G2	G1	h1	f									
TNL 65-250	1,5	DN 65 - DN 65	275	480	570	235	245	135	160	20	1B MiL	A3	-	70,5				
	2,2		305		620				180	20					1C MiL	A3	-	72,5
	3		205		620				180	20					1C MiL	A3	-	73
	4		324		639				180	20					1C MiL	A3	-	85
	5,5		375		715				205	30					2A MiL	A3	F4	107



PERFORMANCE CURVES

TNL 80-160
50 Hz - 1450 rpm

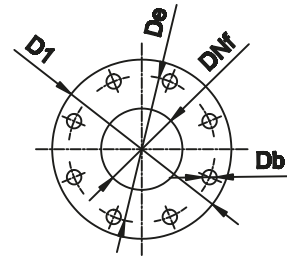
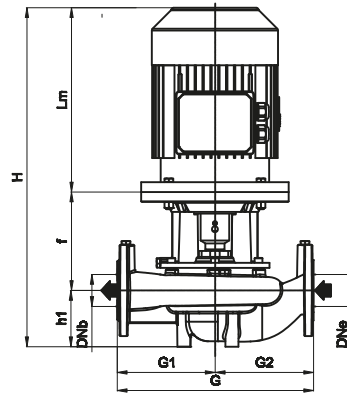

EN1092-1 PN16				
DNf	D1	De	Db	Qty.
80	200	160	18	8
80	200	160	18	8

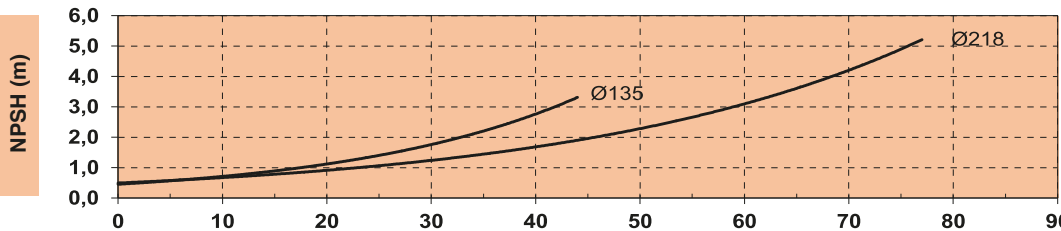
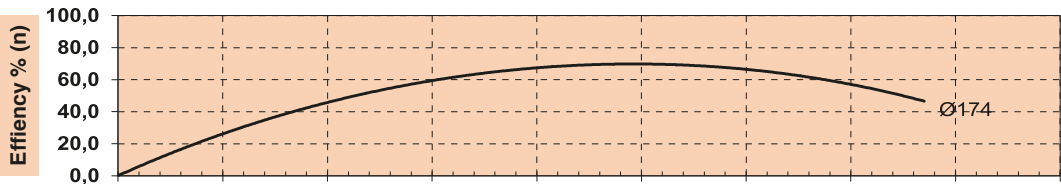
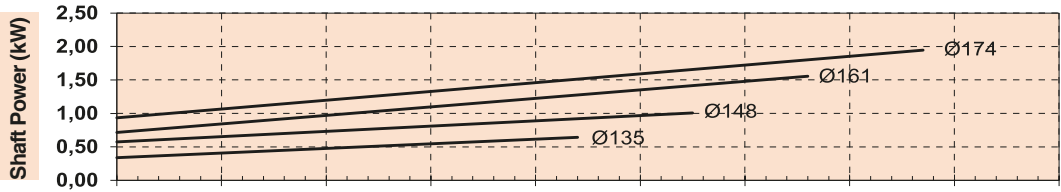
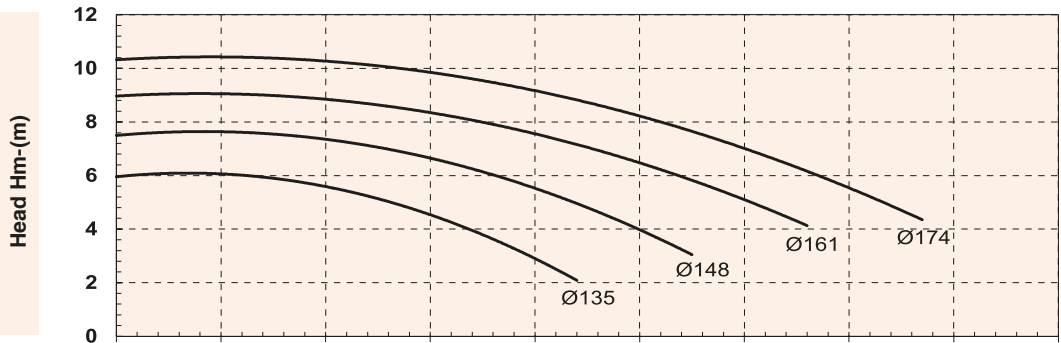

Capacity - Q-(m³/h)

Pump Type	kW	DNb-DNe Outlet-Inlet	Dimension							Mec. Seal Diameter	Shaft and Coupling	Motor Padestal	Motor Flange	Weight (kg.)	
			Lm	G	H	G2	G1	h1	f						
TNL 80-160	0,75		283,5		588,5					170	20	1A MİL	A1	-	46,8
	1,1	DN80-	316,5	440	621,5	220	220	135	170	20	1A MİL	A1	-	48,8	
	1,5	DN80	316,5		621,5				170	20	1B MİL	A1	-	50,8	
	2,2		344,5		669,5				190	20	1B MİL	A1	-	65	



PERFORMANCE CURVES

TNL 80-200
50 Hz - 1450 rpm

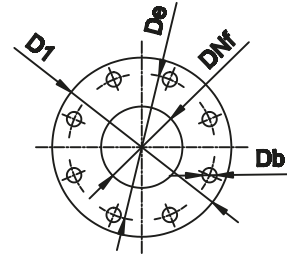
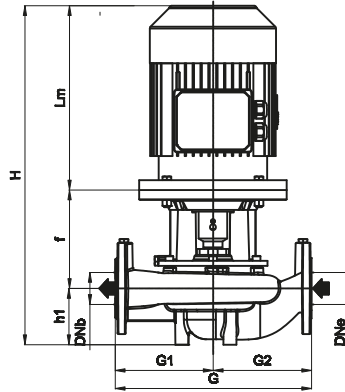

EN1092-1 PN16				
DNf	D1	De	Db	Qty.
80	200	160	18	8
80	200	160	18	8

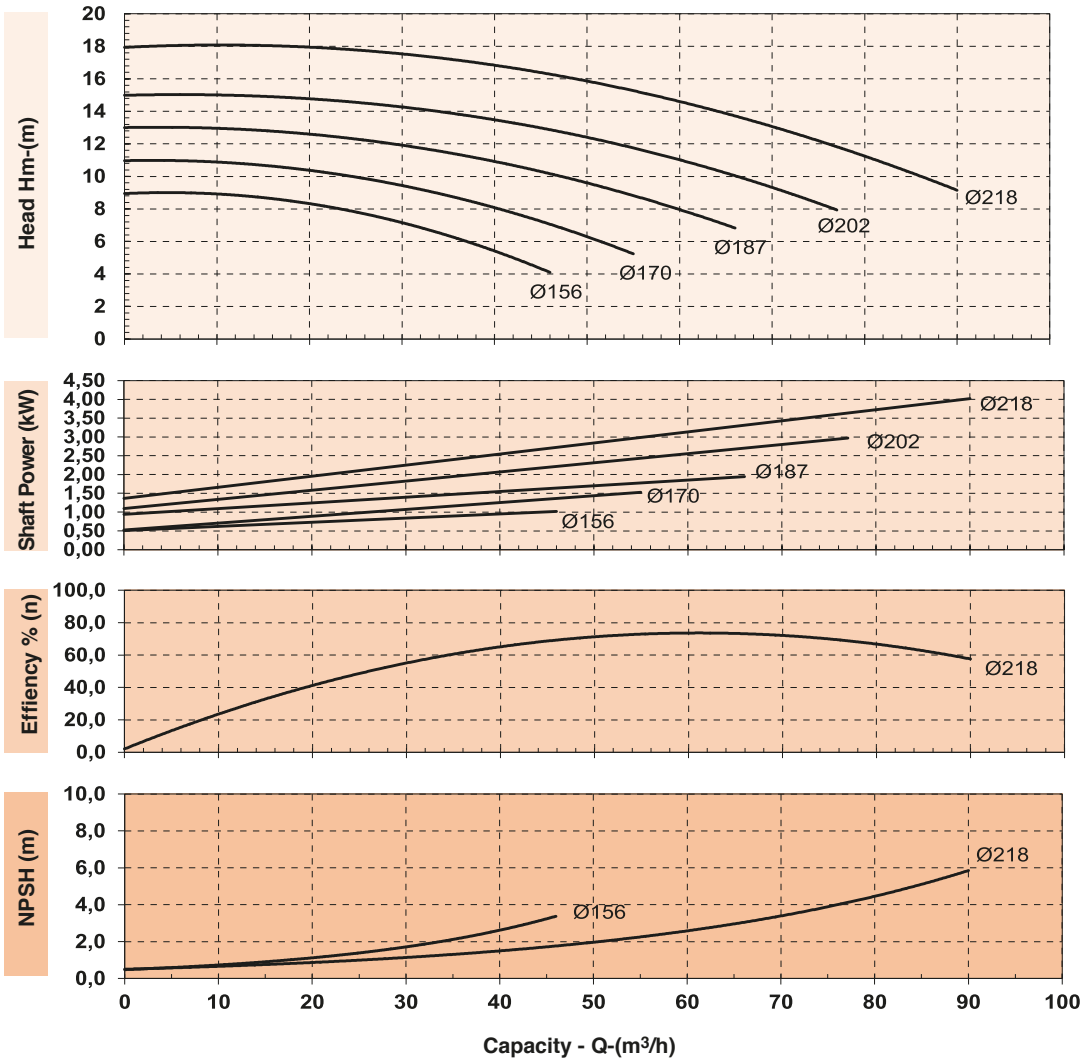

Pump Type	kW	DNb-DNe Outlet-Inlet	Dimension							Mec. Seal Diameter	Shaft and Coupling	Motor Pedestal	Motor Flange	Weight (kg.)
			Lm	G	H	G2	G1	h1	f					
TNL 80-200	1,1	DN80-DN80	316,5	500	716,5	250	250	140	160	20	1A MİL	A2	-	56,8
	1,5		716,5											
	2,2		689,5											
	3		697											
	4		740,5											



PERFORMANCE CURVES

TNL 80-250
50 Hz - 1450 rpm

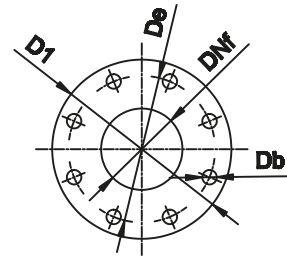
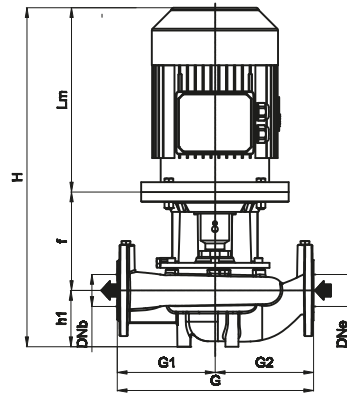

EN1092-1 PN16				
DNf	D1	De	Db	Qty.
80	200	160	18	8
80	200	160	18	8

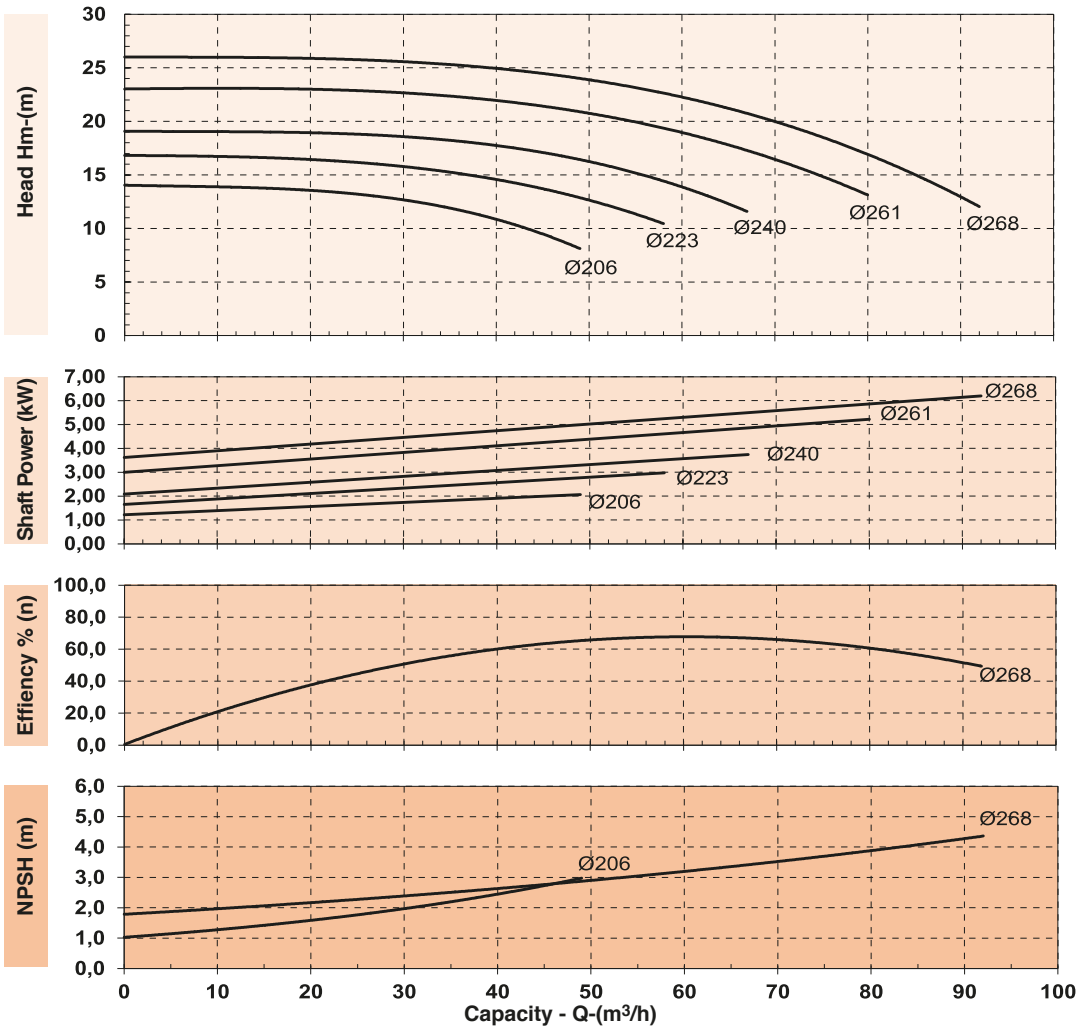

Pump Type	kW	DNb-DNe Outlet-Inlet	Dimension							Mec. Seal Diameter	Shaft and Coupling	Motor Pedestal	Motor Flange	Weight (kg.)				
			Lm	G	H	G2	G1	h1	f									
TNL 80-250	2,2	DN80-DN80	305	550	630	280	270	145	180	20	1C MiL	A3	-	89				
	3		630		180				20						1C MiL	A3	-	90
	4		649		180				20						1C MiL	A3	-	99
	5,5		735		215				30						4A MiL	B2	-	119
	7,5		773		215				30						4A MiL	B2	-	125



PERFORMANCE CURVES

TNL 100-160
50 Hz - 1450 rpm

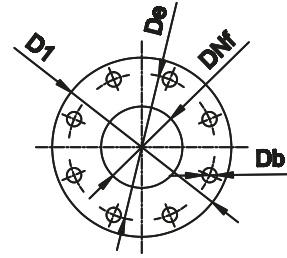
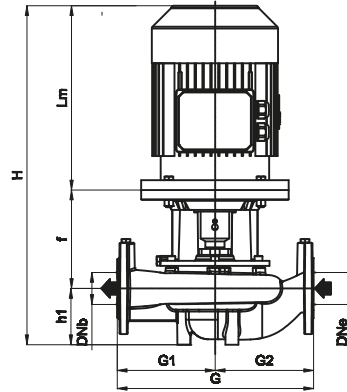

EN1092-1 PN16				
DNf	D1	De	Db	Qty.
100	220	180	18	8
100	220	180	18	8

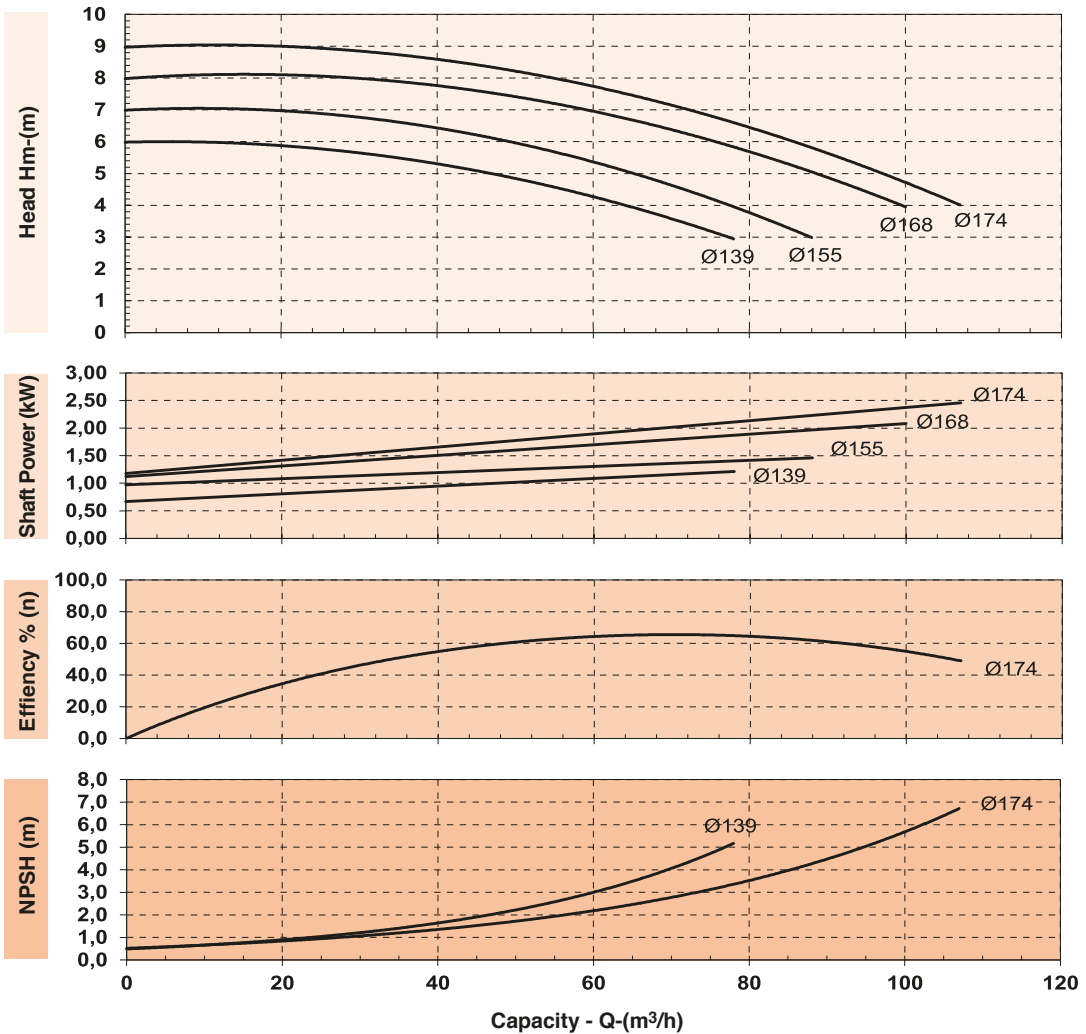

Pump Type	kW	DNb-DNe Outlet-Inlet	Dimension							Mec. Seal Diameter	Shaft and Coupling	Motor Padestal	Motor Flange	Weight (kg.)
			Lm	G	H	G2	G1	h1	f					
TNL 100-160	1,1		250		565					20	1A MİL	A1	-	61
	1,5	DN100-	275		590				160	20	1B MİL	A1	-	63
	2,2	DN100	205	500	640	250	250	155	180	20	1B MİL	A1	F1	74
	3		205		640				180	20	1C MİL	A1	F1	77



PERFORMANCE CURVES

TNL 100-200
50 Hz - 1450 rpm

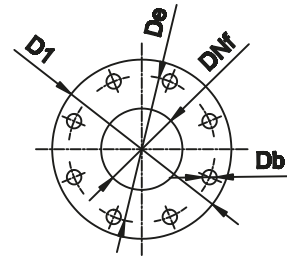
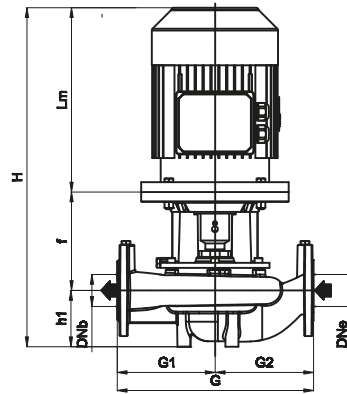

EN1092-1 PN16				
DNf	D1	De	Db	Qty.
100	220	180	18	8
100	220	180	18	8

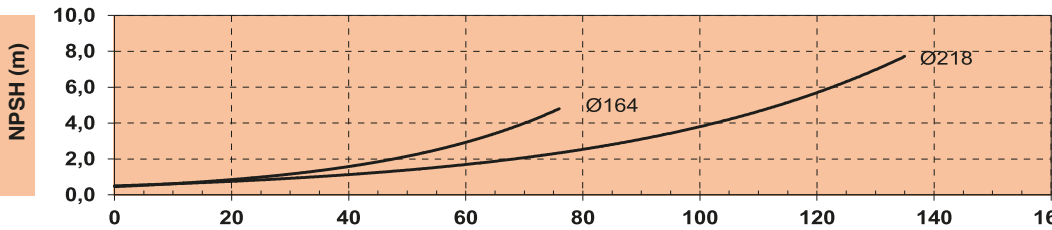
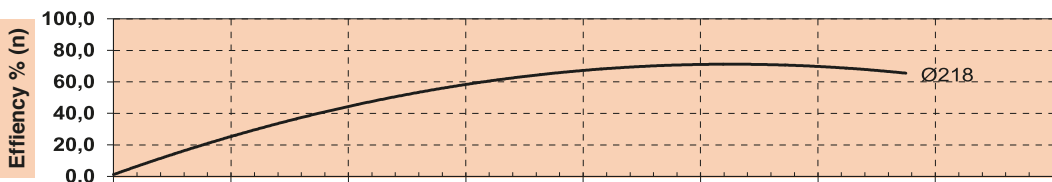
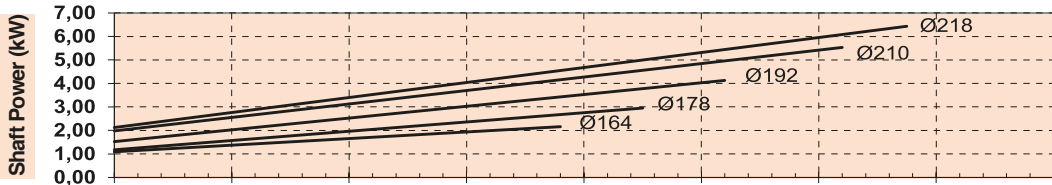
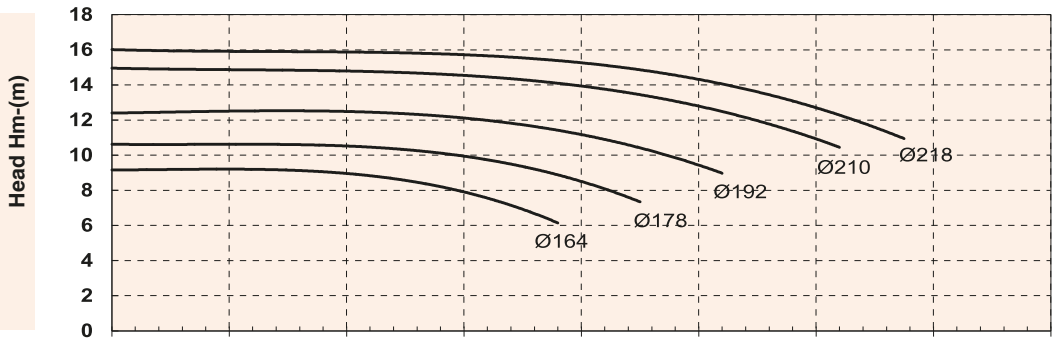

Pump Type	kW	DNb-DNe Outlet-Inlet	Dimension							Mec. Seal Diameter	Shaft and Coupling	Motor Padestal	Motor Flange	Weight (kg.)	
			Lm	G	H	G2	G1	h1	f						
TNL 100-200	2,2	DN100-DN100	305		675					190	20	ML3	B1	-	77
	3		305		675					190	20	ML3	B1	-	843
	4		324	550	694	275	275	180	190	20	ML3	B1	-	91	
	5,5		375		770					215	30	ML4A	B1	F4	114
	7,5		413		808					215	30	ML4A	B1	F4	122



PERFORMANCE CURVES

TNL 100-250 50 Hz - 1450 rpm

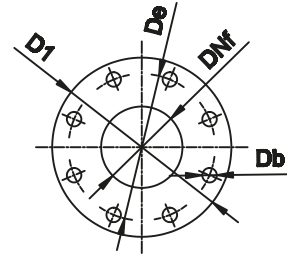
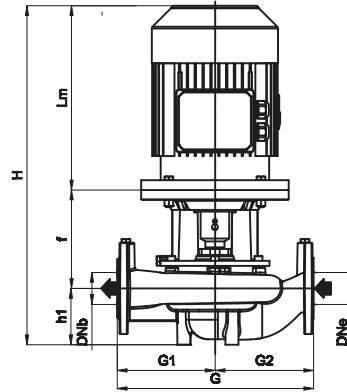

EN1092-1 PN16				
DNf	D1	De	Db	Qty.
100	220	180	18	8
100	220	180	18	8

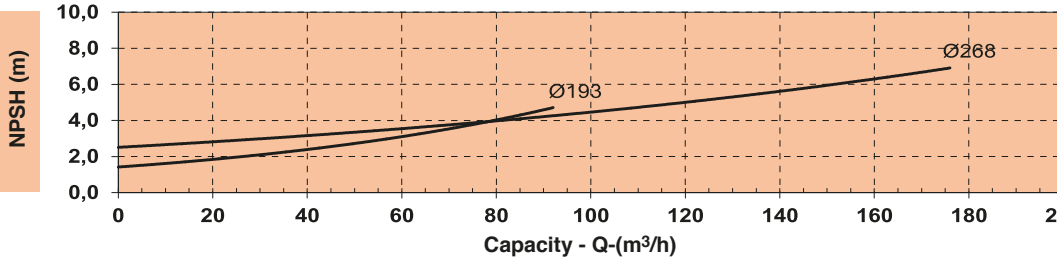
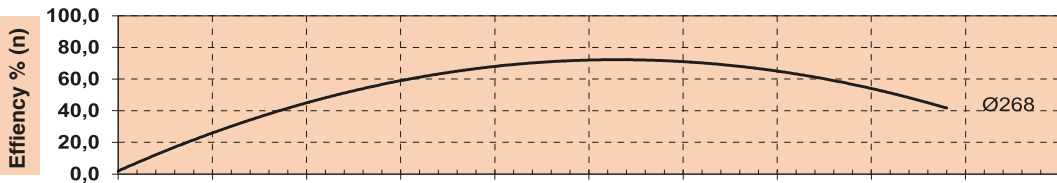
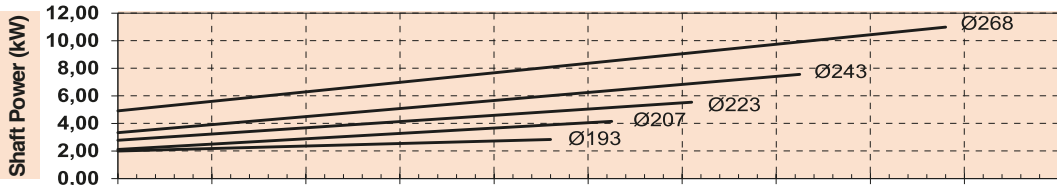
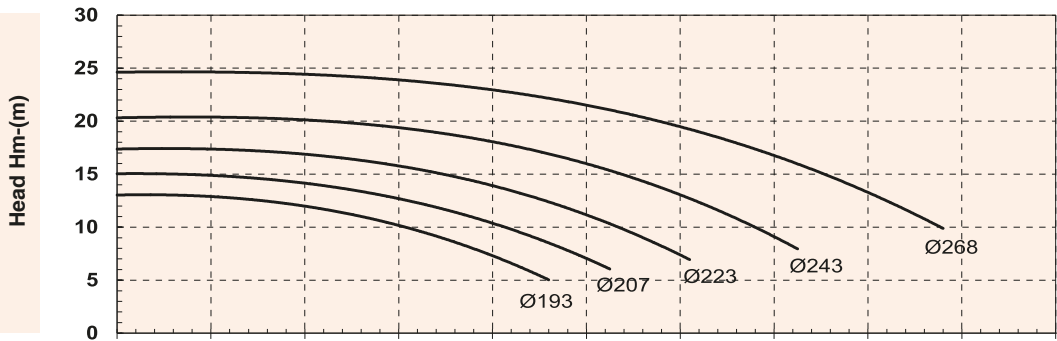

Pump Type	kW	DNb-DNe Outlet-Inlet	Dimension							Mec. Seal Diameter	Shaft and Coupling	Motor Pedestal	Motor Flange	Weight (kg.)
			Lm	G	H	G2	G1	h1	f					
TNL 100-250	3	DN100-DN100	305	600	675	280	320	190	189	30	3A MİL	B2k	T4	105
	4		324		694				180					
	5,5		375		780				215					
	7,5		413		818				215					
	11		484		914				240					



PERFORMANCE CURVES

TNL 100-315
50 Hz - 1450 rpm

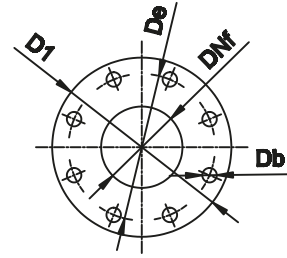
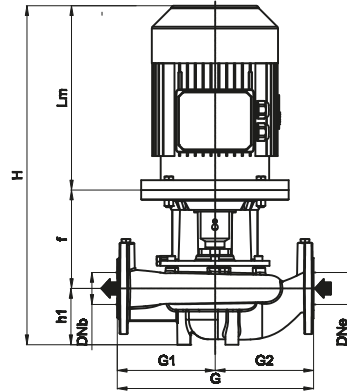

EN1092-1 PN16				
DNf	D1	De	Db	Qty.
100	220	180	18	8
100	220	180	18	8

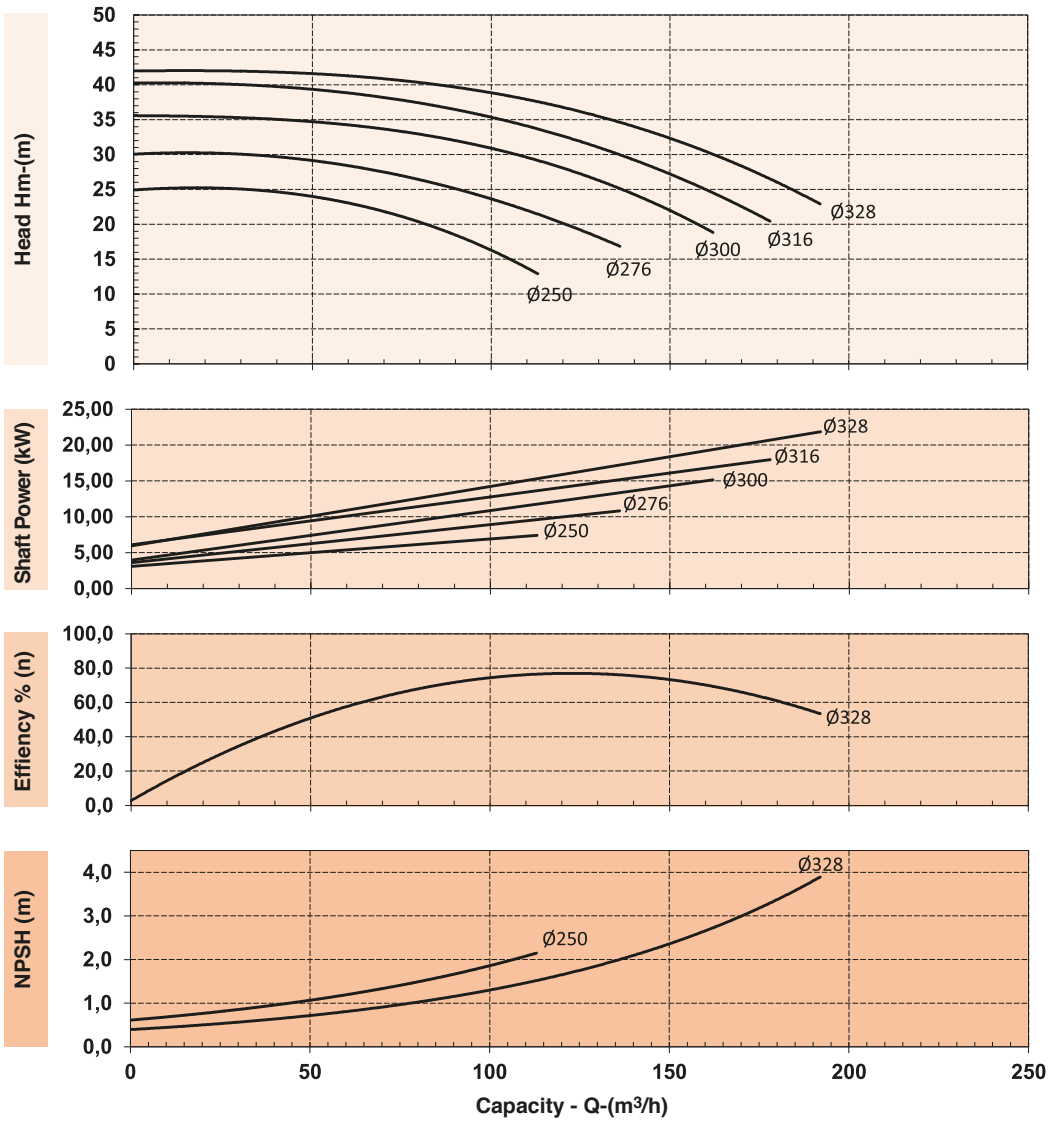

Pump Type	kW	DNb-DNe Outlet-Inlet	Dimension							Mec. Seal Diameter	Shaft and Coupling	Motor Padestal	Motor Flange	Weight (kg.)
			Lm	G	H	G2	G1	h1	f					
TNL 100-315	11	DN100-DN100	466	650	896	315	335	190	240	30	4B MiL	B3	-	225
	15		466		896									
	18,5		519		949									
	22		519		949									



PERFORMANCE CURVES

TNL 125-200
50 Hz - 1450 rpm

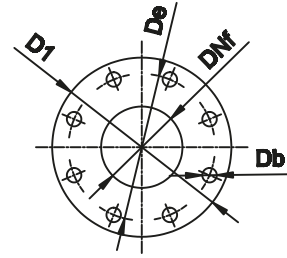
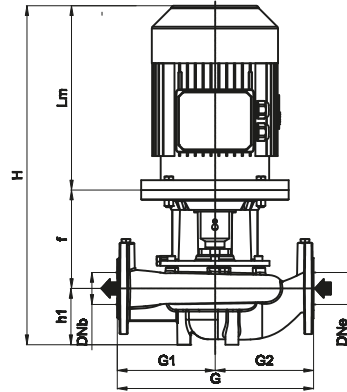

EN1092-1 PN16				
DNf	D1	De	Db	Qty.
125	250	210	18	8
125	250	210	18	8

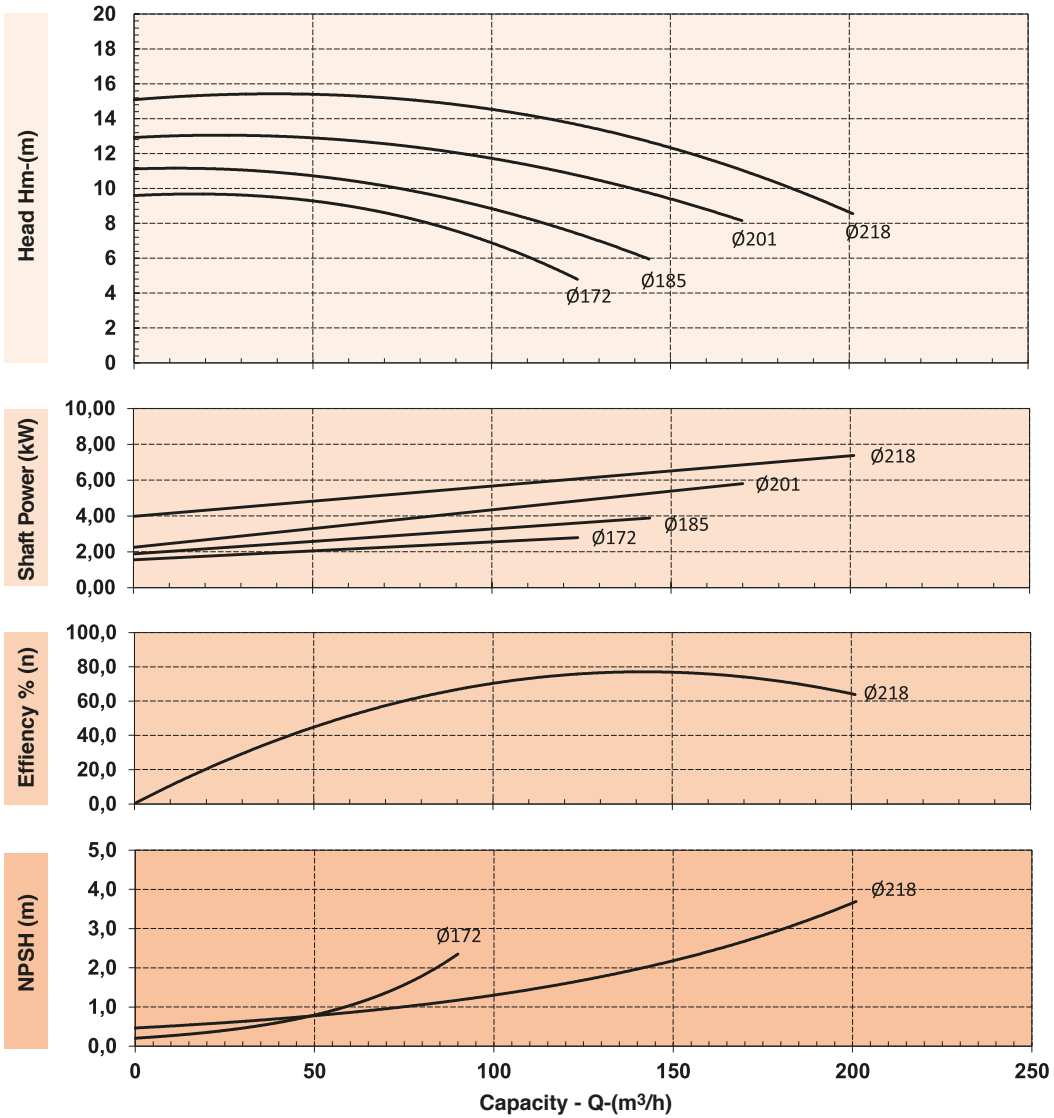

Pump Type	kW	DNb-DNe Outlet-Inlet	Dimension							Mec. Seal Diameter	Shaft and Coupling	Motor Padestal	Motor Flange	Weight (kg.)	
			Lm	G	H	G2	G1	h1	f						
TNL 125-200	3	DN125-DN125	272	600	672	300	300			190	30	3A MİL	B1	-	99
	4		335,5		735,5					190	30	3A MİL	B1	-	107
	5,5		395,5		820,5					215	30	4A MİL	B1	F4	130
	7,5		395,5		820,5					215	30	4A MİL	B1	F4	137



PERFORMANCE CURVES

TNL 125-250
50 Hz - 1450 rpm

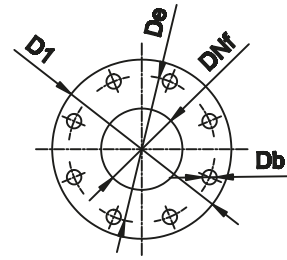
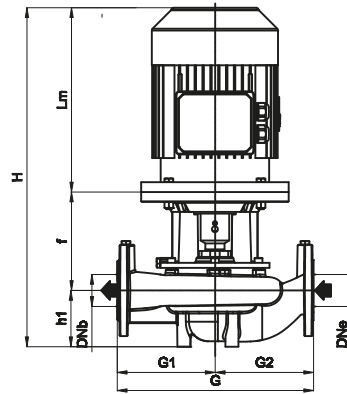

EN1092-1 PN16				
DNf	D1	De	Db	Qty.
125	250	210	18	8
125	250	210	18	8

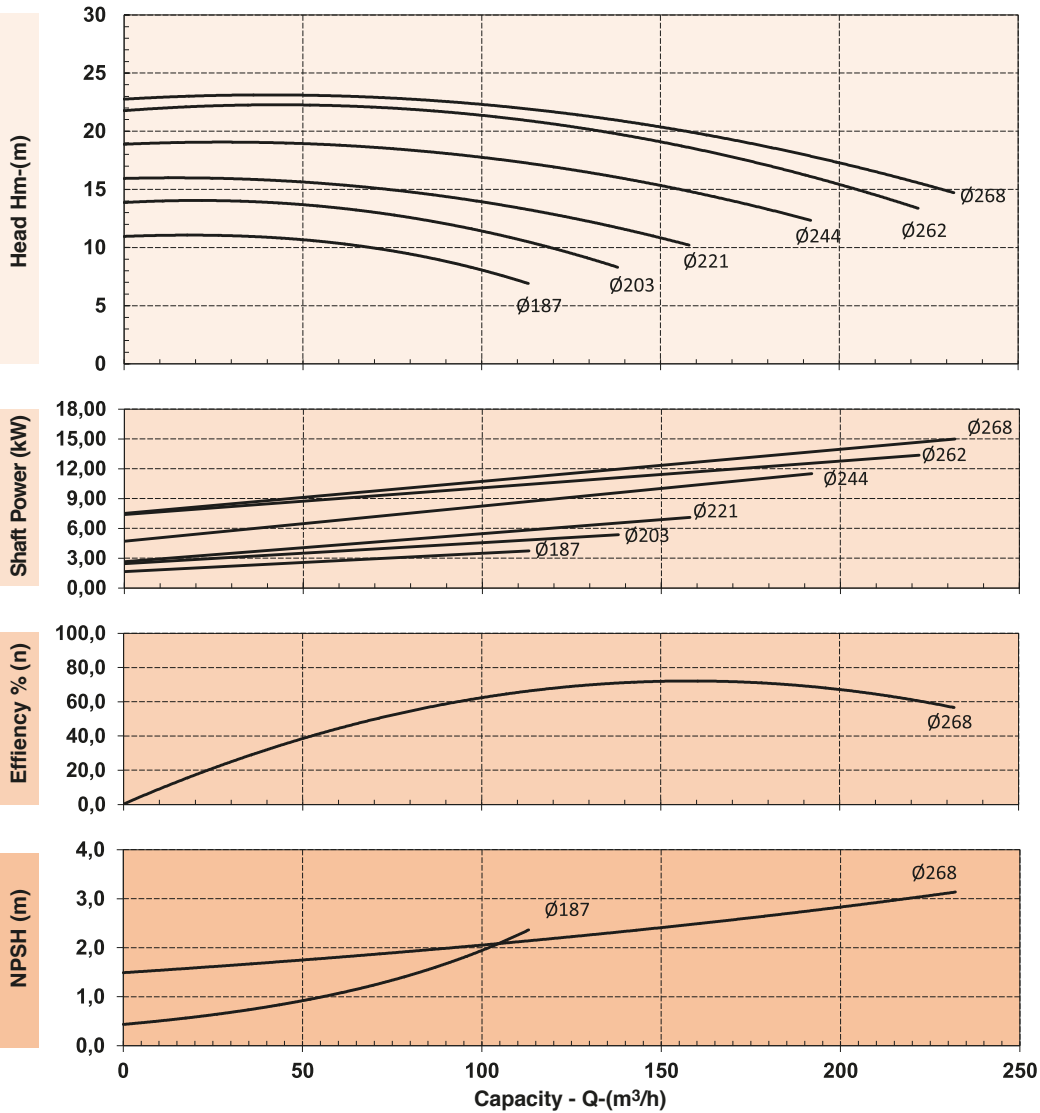

Pump Type	kW	DNb-DNe Outlet-Inlet	Dimension							Mec. Seal Diameter	Shaft and Coupling	Motor Padestal	Motor Flange	Weight (kg.)				
			Lm	G	H	G2	G1	h1	f									
TNL 125-250	5,5	DN125-DN125	395,5	650	820,5	300	350	210	215	30	4A MİL	B2	F7	138				
	7,5		820,5		215										30	4A MİL	B2	146
	11		916		240										30	4B MİL	B2	220
	15		916		240										30	4B MİL	B2	254
	18,5		969		240										30	4C MİL	B2	274



PERFORMANCE CURVES

TNL 125-315 50 Hz - 1450 rpm

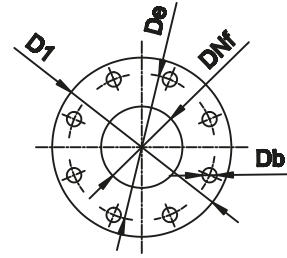
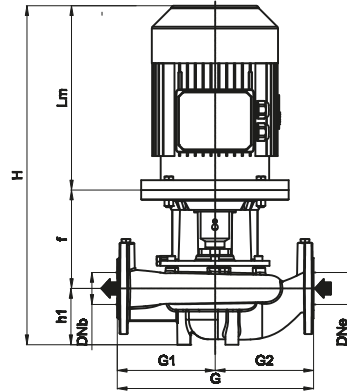

EN1092-1 PN16				
DNf	D1	De	Db	Qty.
125	250	210	18	8
125	250	210	18	8

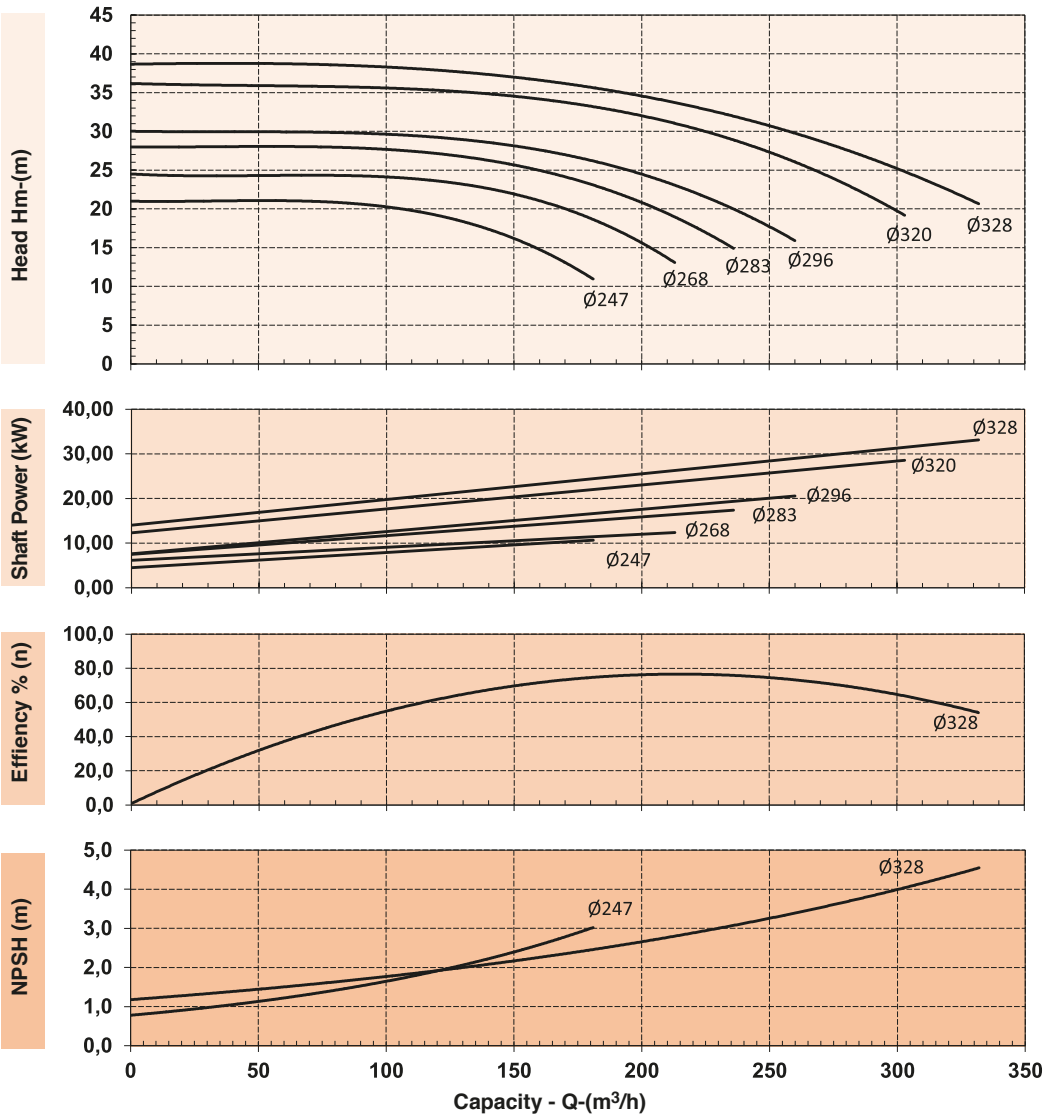

Pump Type	kW	DNb-DNe Outlet-Inlet	Dimension						Mec. Seal Diameter	Shaft and Coupling	Motor Padestal	Motor Flange	Weight (kg.)	
			Lm	G	H	G2	G1	h1						f
TNL 125-315	11	DN125-DN125	466	700	946	330	370	210	270	30	4B MIL	B3	-	245
	15		466		946				270	30	4B MIL	B3	-	251
	18,5		519		999				270	30	4K MIL	B3	-	285
	22		519		999				270	30	4K MIL	B3	-	312
	30		555		1065				300	35	MIL8+KAP.6	B3	F9	393
	37		555		850				85	35	MIL11+KAP.7	B3	F10	413



PERFORMANCE CURVES

TNL 150-200
50 Hz - 1450 rpm

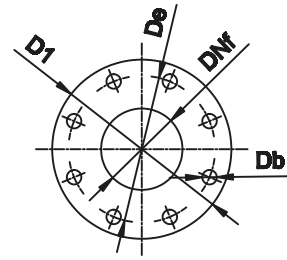
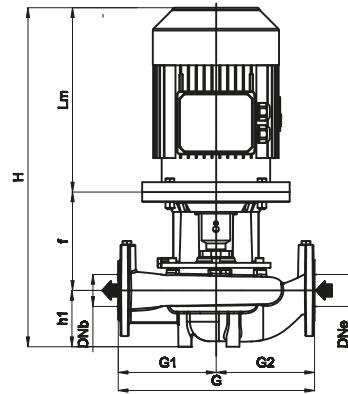

EN1092-1 PN16				
DNf	D1	De	Db	Qty.
150	285	240	22	8
150	285	240	22	8

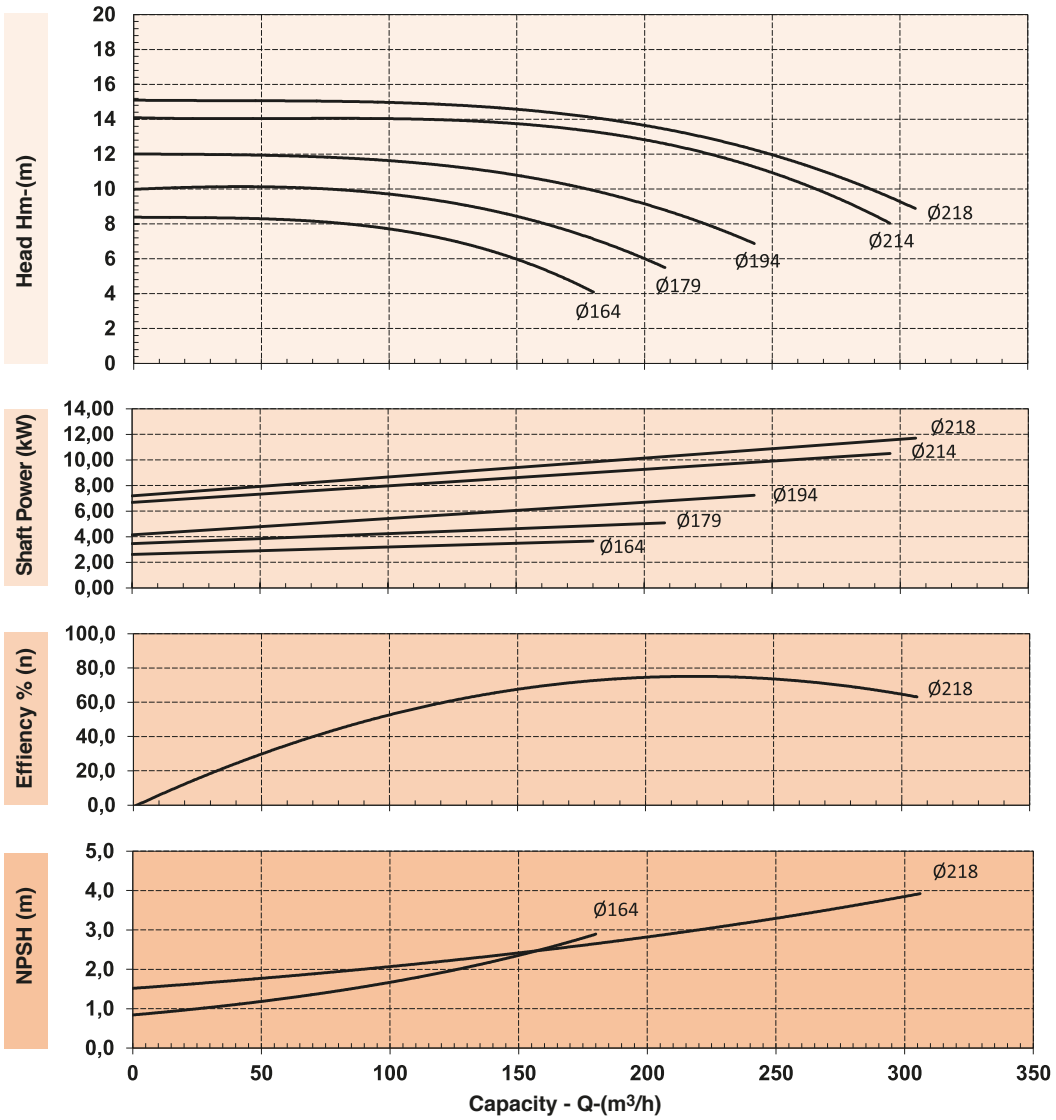

Pump Type	kW	DNb-DNe Outlet-Inlet	Dimension							Mec. Seal Diameter	Shaft and Coupling	Motor Padestal	Motor Flange	Weight (kg.)				
			Lm	G	H	G2	G1	h1	f									
TNL 150-200	4	DN150-DN150	395,5	650	755,5	315	335	190	230	30	3A MiL	B1	F4	142				
	5,5		395,5		840,5				255						30	4A MiL	B1	157
	7,5		466		865,5				280						30	4A MiL	B1	167
	11		466		936				280						30	4B MiL	B1	232
	15		519		936				280						30	4B MiL	B1	264



PERFORMANCE CURVES

TNL 150-250
50 Hz - 1450 rpm

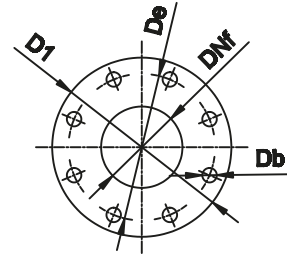
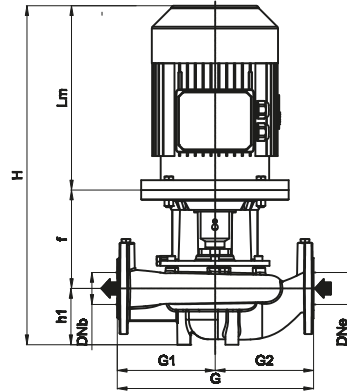

EN1092-1 PN16				
DNf	D1	De	Db	Qty.
150	285	240	22	8
150	285	240	22	8

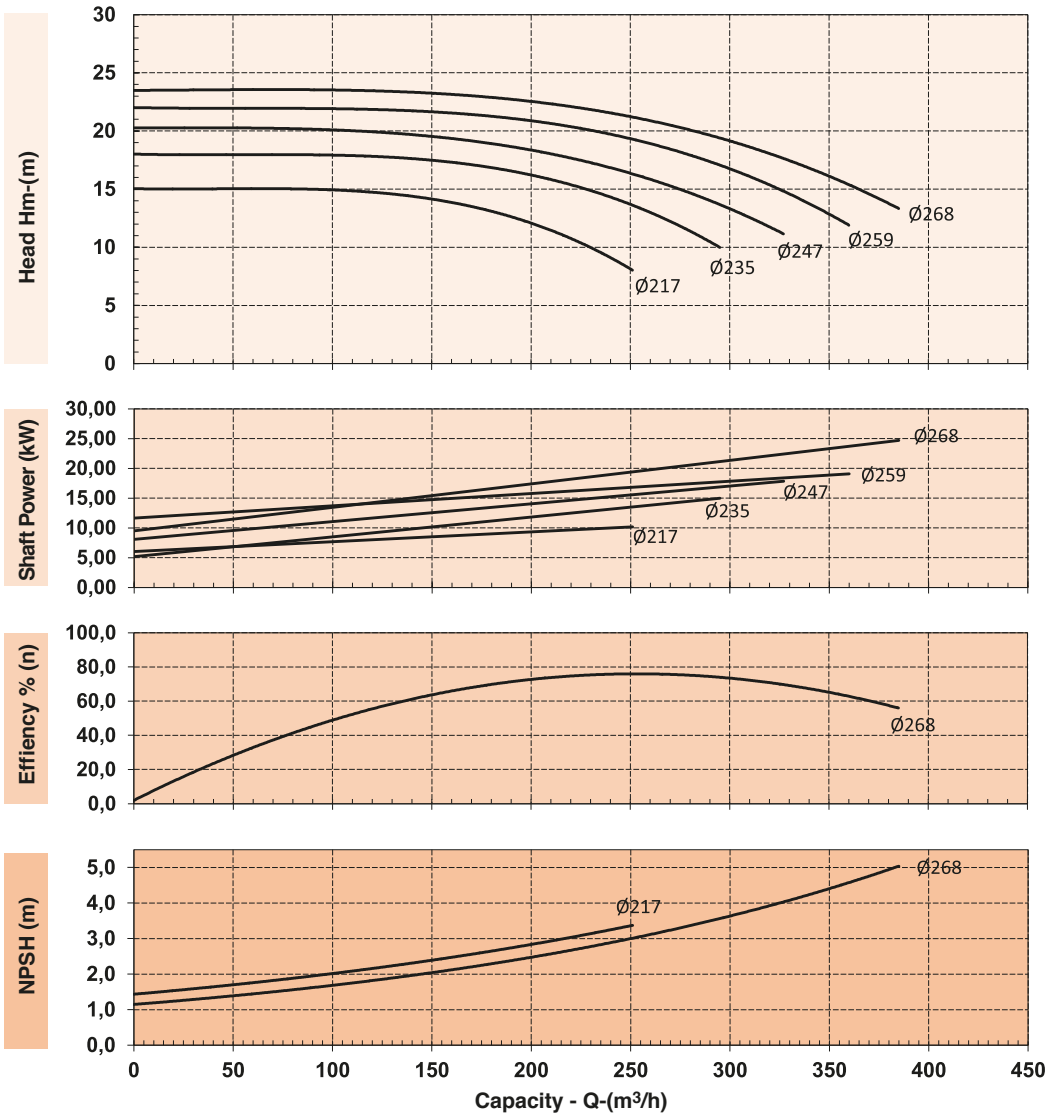

Pump Type	kW	DNb-DNe Outlet-Inlet	Dimension						Mec. Seal Diameter	Shaft and Coupling	Motor Padestal	Motor Flange	Weight (kg.)	
			Lm	G	H	G2	G1	h1						f
TNL 150-250	11	DN150-DN150	466	650	946	355	315	180	300	30	4B MİL	B2	F7	238
	15		466		946				300	30	4B MİL	B2	F7	273
	18,5		519		999				300	30	4C MİL	B2	F7	294
	22		519		999				300	30	4C MİL	B2	F7	316
	30		555		1065				330	35	MİL8+KAP.6	B2	F8	383



PERFORMANCE CURVES

TNL 150-315
50 Hz - 1450 rpm

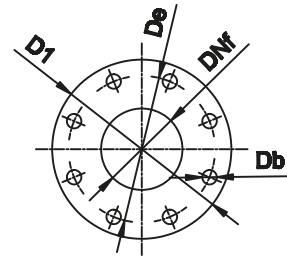
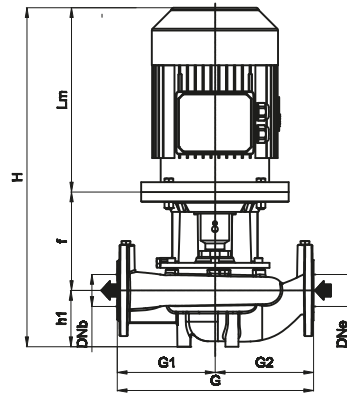

EN1092-1 PN16				
DNf	D1	De	Db	Qty.
150	285	240	22	8
150	285	240	22	8

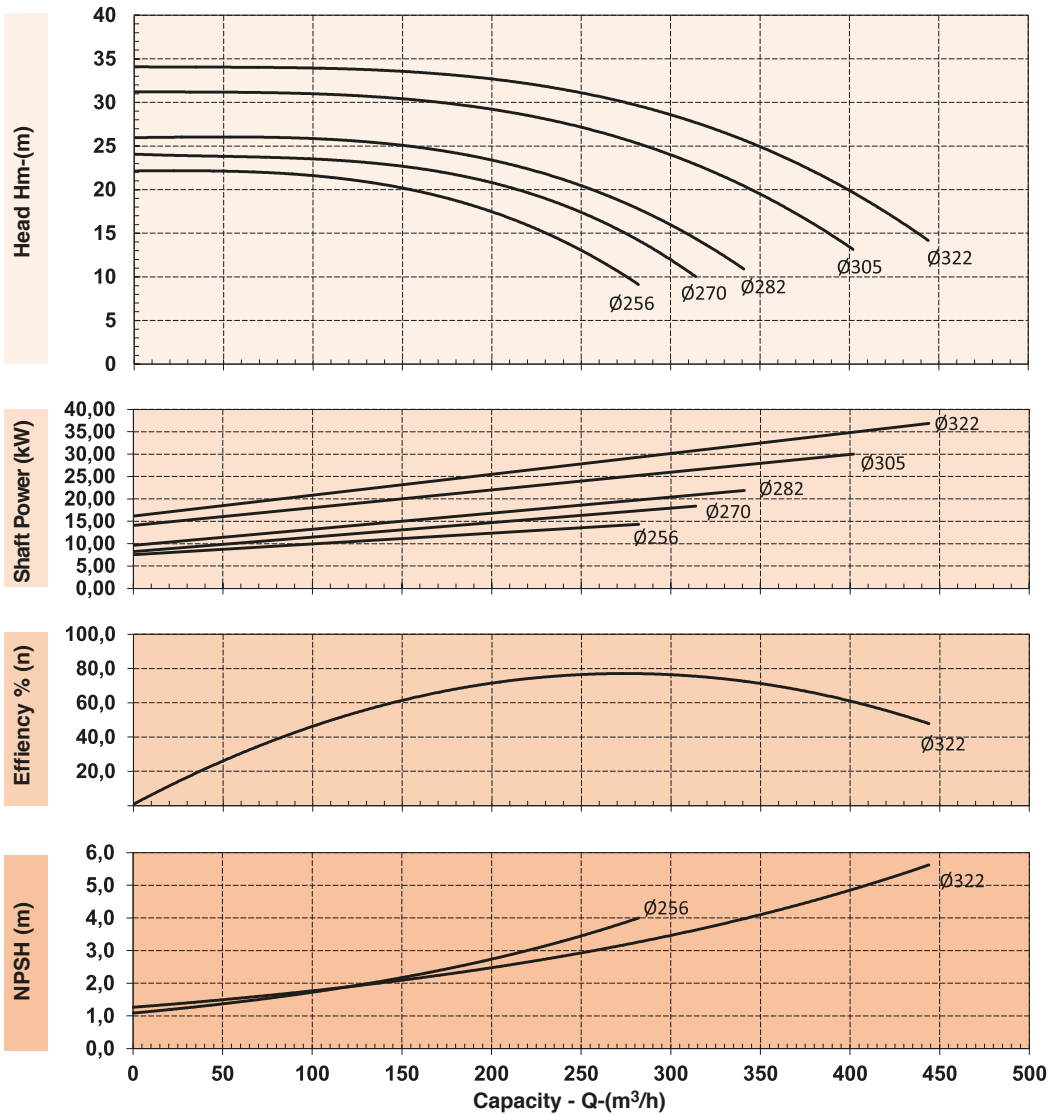

Pump Type	kW	DNb-DNe Outlet-Inlet	Dimension						Mec. Seal Diameter	Shaft and Coupling	Motor Pedestal	Motor Flange	Weight (kg.)	
			Lm	G	H	G2	G1	h1						f
TNL 150-315	15	DN150-DN150	466	380	981	380	390	210	305	30	6A MIL	C2	-	275
	18,5		519		1034				305	30	6B MIL	C2	-	318
	22		519		1034				305	30	6B MIL	C2	-	345
	30		555		1100				335	35	MIL9+KAP.6	C2	F9	419
	37		625		955				120	35	MIL11B+KAP.7A	C2	F10	451

