

PERFORMANCE CURVES

**TNL 40-160**  
50 Hz - 2900 rpm

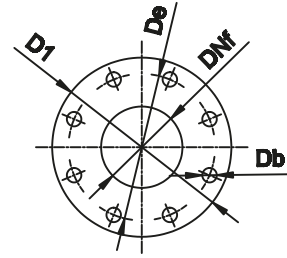

EN1092-1 PN16				
DNf	D1	De	Db	Qty.
40	150	110	18	4
40	150	110	18	4

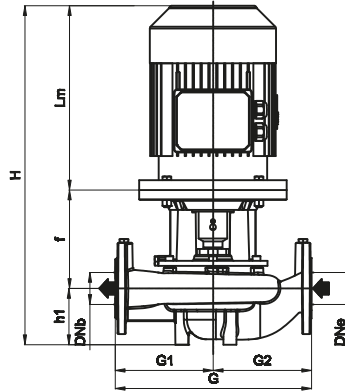
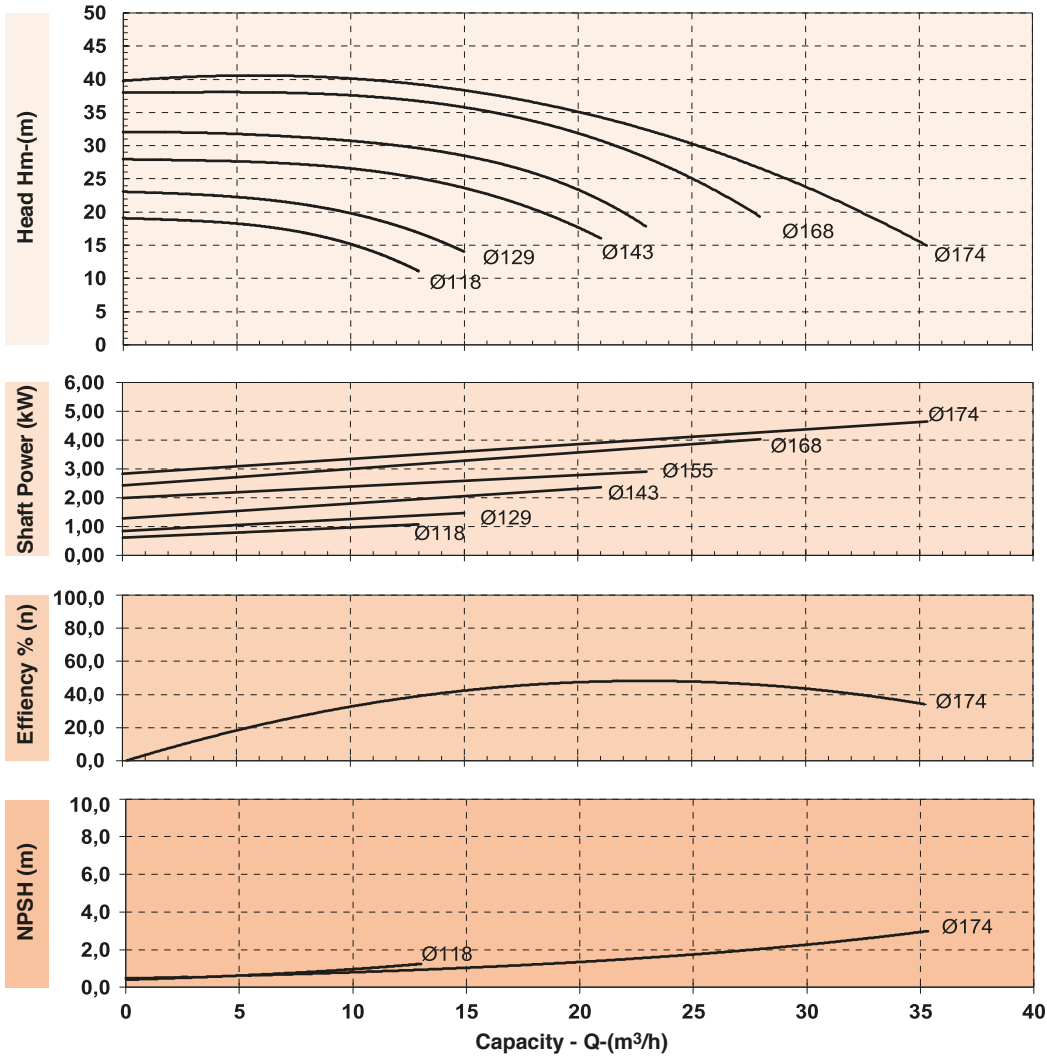

Pump Type	kW	DNb- DNc Outlet- Inlet	Dimension							Mec. Seal Diameter	Shaft and Coupling	Motor Pedestal	Motor Flange	Weight (kg.)
			Lm	G	H	G2	G1	h1	f					
TNL 40-160	1,1	DN 40- DN 40	316,5	320	556,5	160	160	80	160	20	1A Mil	A1	-	41,8
	1,5		316,5		556,5				160	20	1B Mil	A1	-	42,4
	2,2		344,5		584,5				160	20	1B Mil	A1	-	42,8
	3		352		592				160	20	1C Mil	A1	F1	51,5
	4		395,5		655,5				180	20	1C Mil	A1	F1	59
	5,5		440,5		700,5				180	30	2A Mil	A1	F2	78



**PERFORMANCE CURVES**

**TNL 40-200**  
50 Hz - 2900 rpm

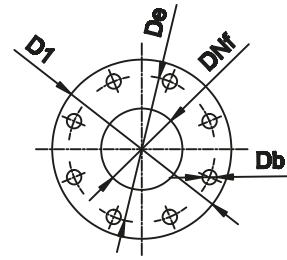
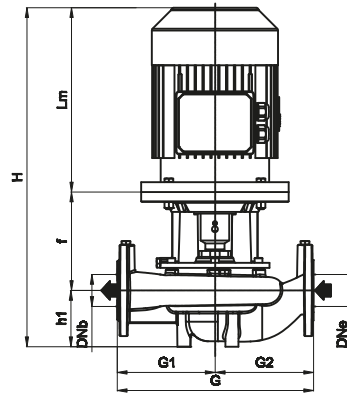

EN1092-1 PN16				
DNf	D1	De	Db	Qty.
40	150	110	18	4
40	150	110	18	4

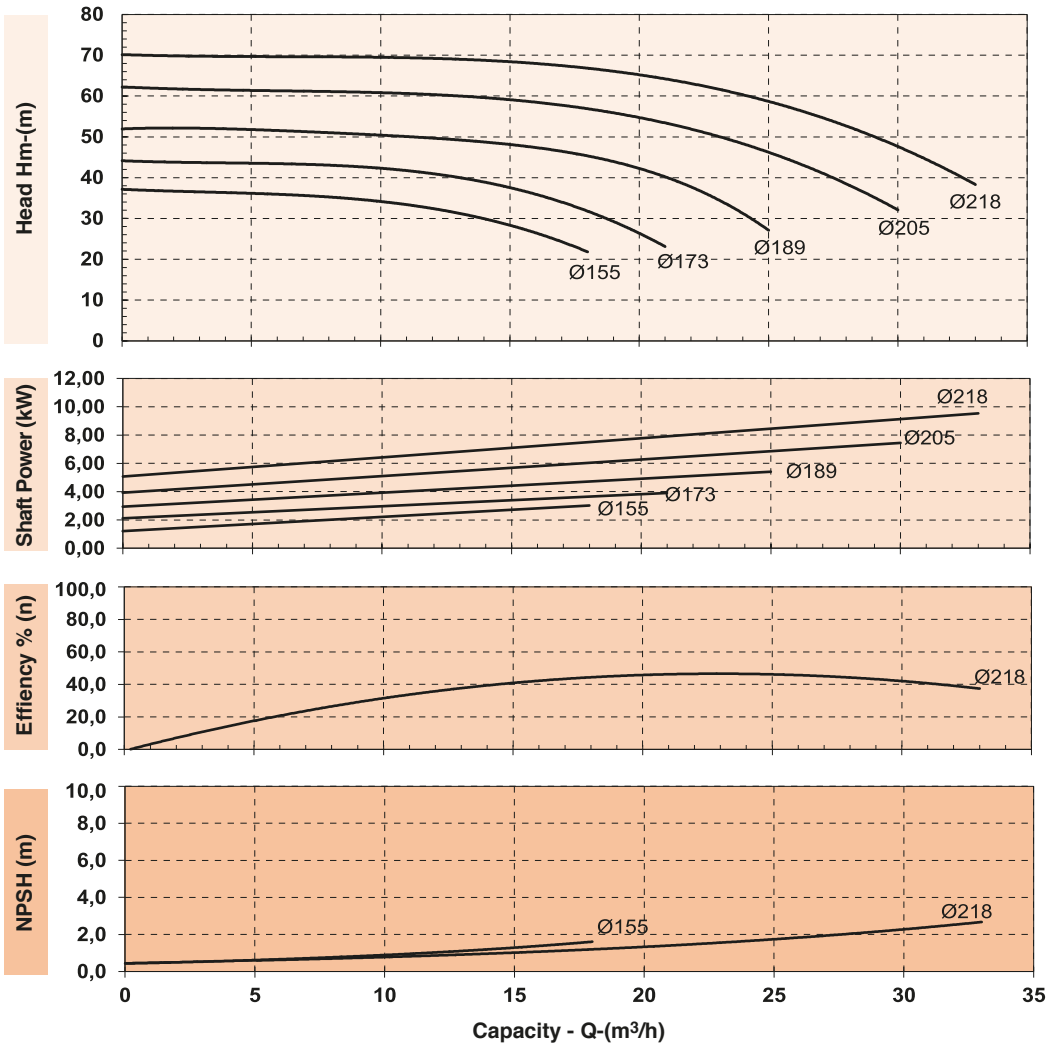

Pump Type	kW	DNb- DNe Outlet- Inlet	Dimension							Mec. Seal Diameter	Shaft and Coupling	Motor Pedestal	Motor Flange	Weight (kg.)			
			Lm	G	H	G2	G1	h1	f								
TNL 40-200	3	DN40- DN40	352	380	727	190	190	95	180	20	1C Mil	A2	-	54,8			
	4		395,5		670,5				180					1C Mil	A2	-	62,7
	5,5		440,5		740,5				205					2A Mil	A2	F4	83,9
	7,5		475,5		775,5				205					2A Mil	A2	F4	89,9
	11		576		876				230					30	2B Mil	A2	F5



PERFORMANCE CURVES

**TNL 40-250**  
50 Hz - 2900 rpm

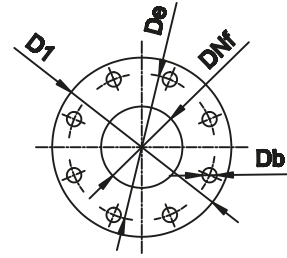
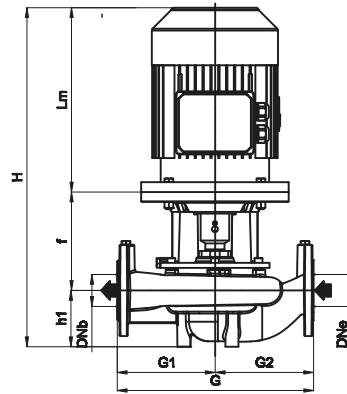

EN1092-1 PN16				
DNf	D1	De	Db	Qty.
40	150	110	18	4
40	150	110	18	4

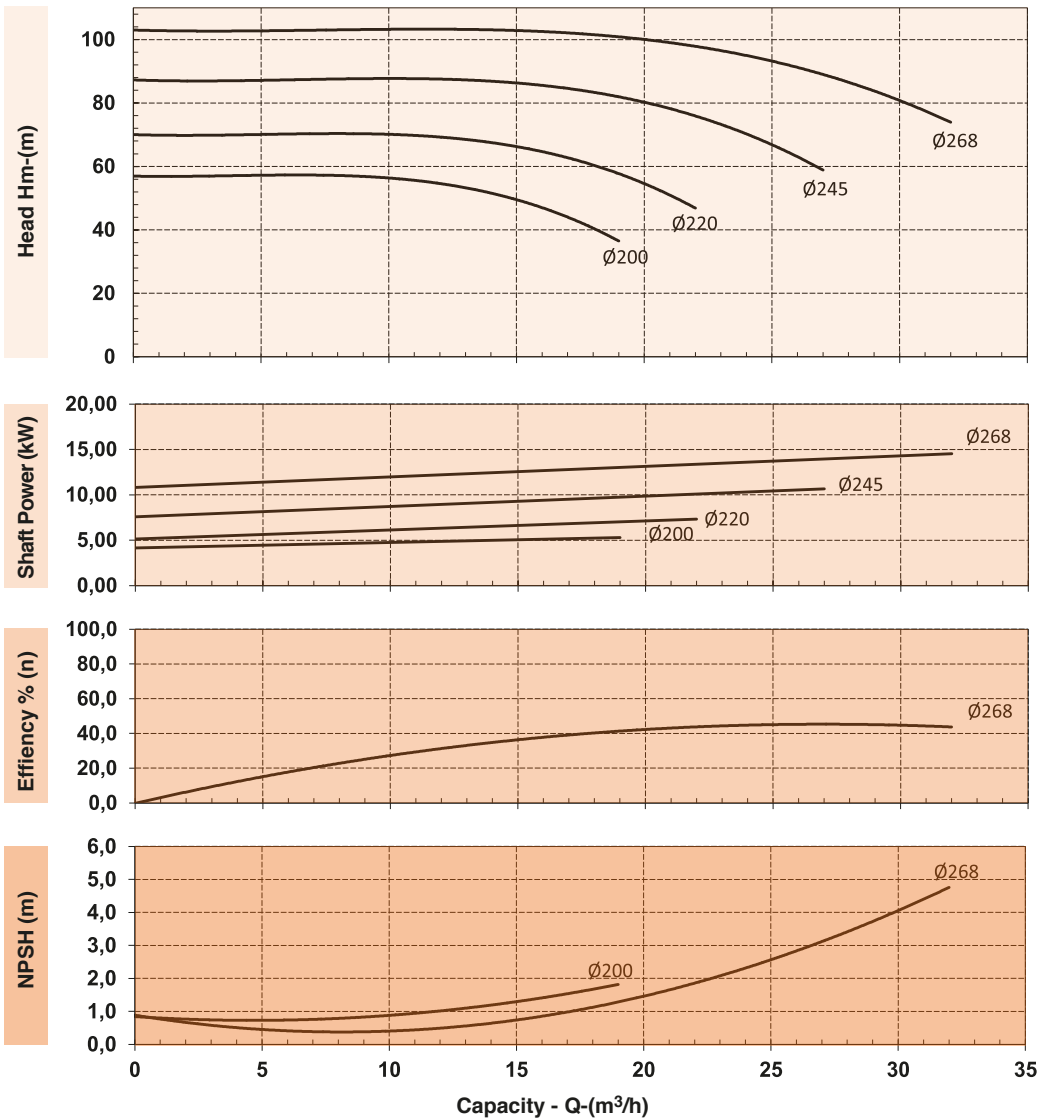

Pump Type	kW	DNb-DNe Outlet-Inlet	Dimension							Mec. Seal Diameter	Shaft and Coupling	Motor Pedestal	Motor Flange	Weight (kg.)
			Lm	G	H	G2	G1	h1	f					
TNL40-250	5,5	DN 40 - DN 4 0	360,5	440	675,5	225	215	100	215	30	2A	A3	F4	140
	7,5		360,5		675,5				215	30	2A	A3	F4	145
	11		466		806				240	30	2B	A3	F5	162
	15		466		806				240	30	2B	A3	F5	180



**PERFORMANCE CURVES**

**TNL 50-160**  
50 Hz - 2900 rpm

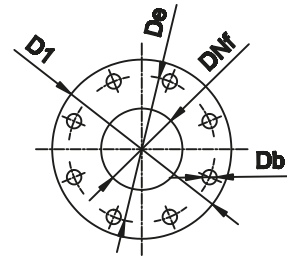
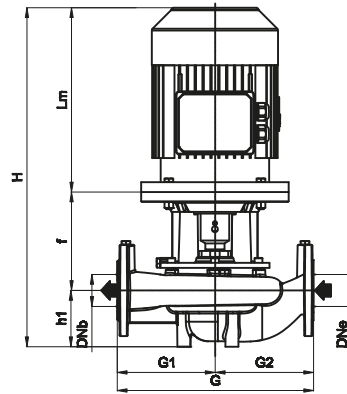

EN1092-1 PN16				
DNf	D1	De	Db	Qty.
50	165	125	18	4
50	165	125	18	4

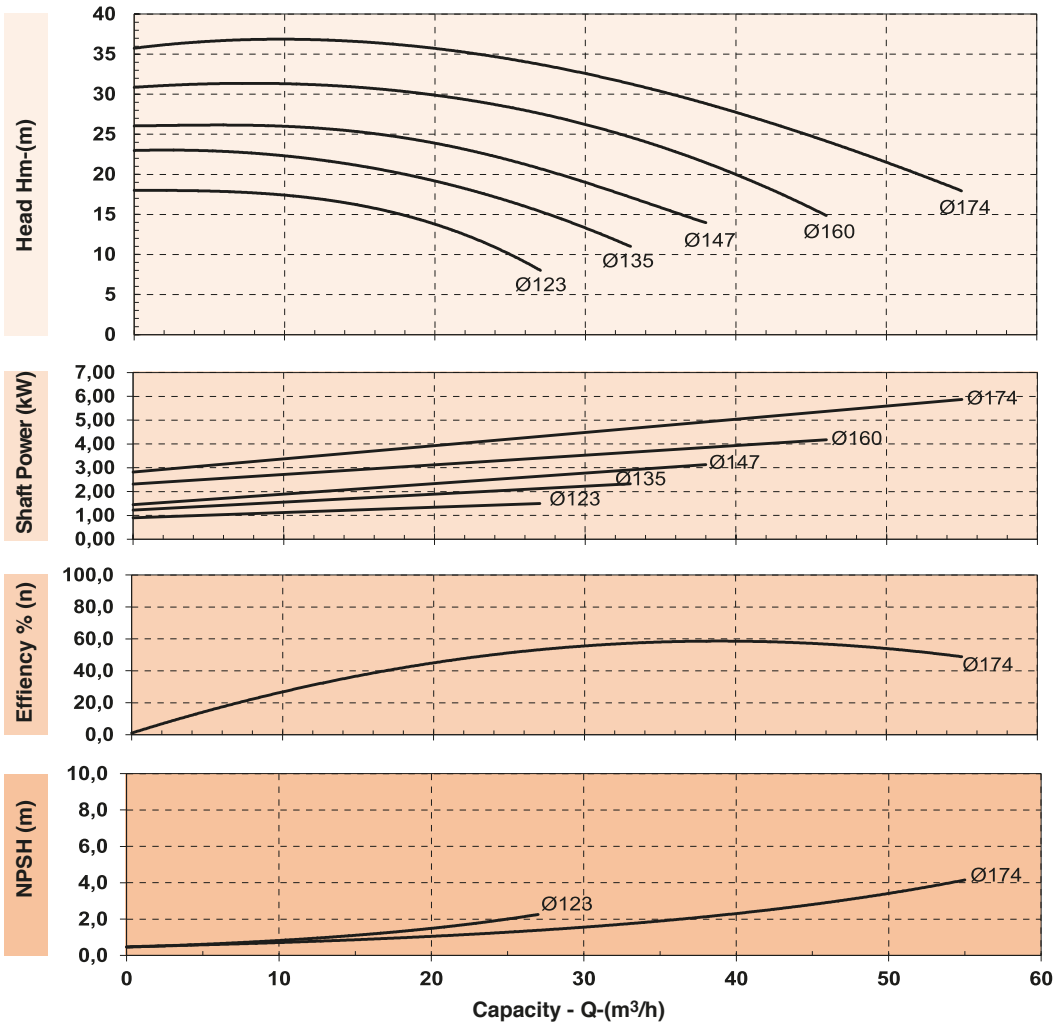

Pump Type	kW	DNb- DNc Outlet- Inlet	Dimension							Mec. Seal Diameter	Shaft and Coupling	Motor Padestal	Motor Flange	Weight (kg.)
			Lm	G	H	G2	G1	h1	f					
TNL 50-160	1,5	DN50- DN50	316,5	360	576,5	180	180	100	160	20	1B MİL	A1	-	42,7
	2,2		344,5		604,5				160	20	1B MİL	A1	-	42,9
	3		352		632				180	20	1C MİL	A1	F1	54,4
	4		395,5		675,5				180	20	1C MİL	A1	F1	62,4
	5,5		440,5		720,5				200	30	2A MİL	A1	F2	80,1
	7,5		475,5		755,5				200	30	2A MİL	A1	F2	81,2



PERFORMANCE CURVES

**TNL 50-200**  
50 Hz - 2900 rpm

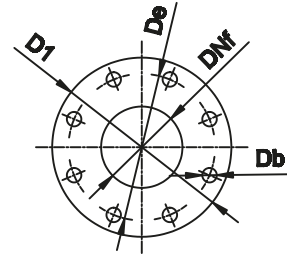
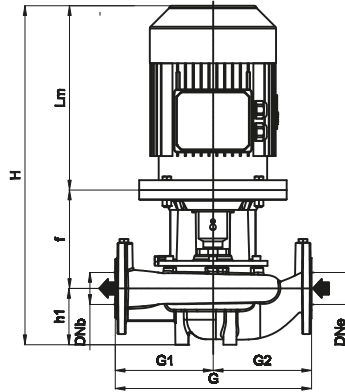

EN1092-1 PN16				
DNf	D1	De	Db	Qty.
50	165	125	18	4
50	165	110	18	4

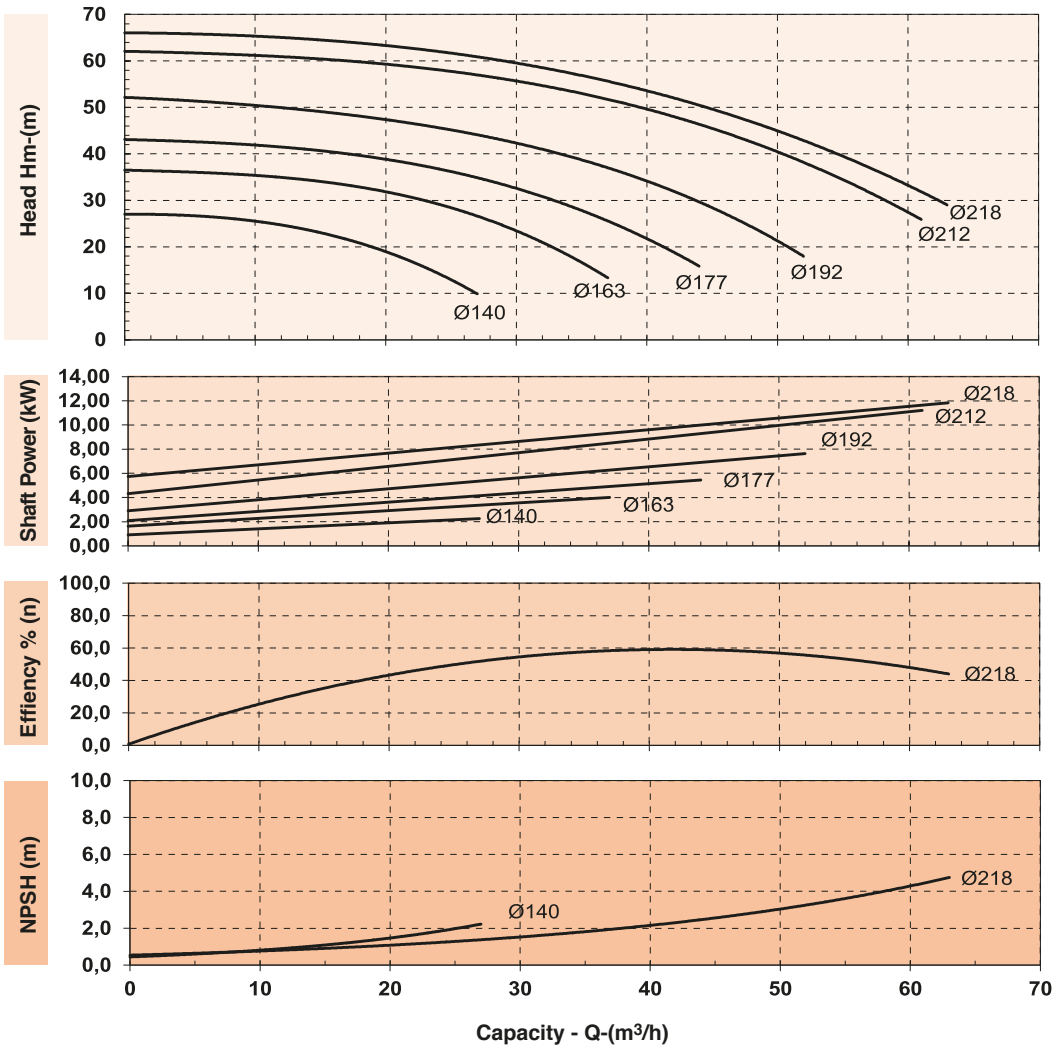

Pump Type	kW	DNb-DNe Outlet-Inlet	Dimension							Mec. Seal Diameter	Shaft and Coupling	Motor Padestal	Motor Flange	Weight (kg.)
			Lm	G	H	G2	G1	h1	f					
TNL 50-200	5,5	DN50-DN50	440,5	400	755	200	200	110	205	30	2A MİL	A2	F4	88,8
	7,5		475,5		790,5				205					89,3
	11		576		916				230					136,9
	15		576		916				230					137,1



## PERFORMANCE CURVES

**TNL 50-250**  
50 Hz - 2900 rpm

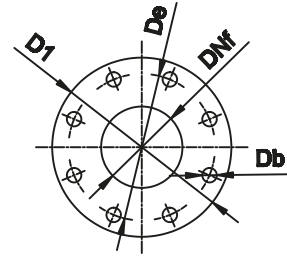
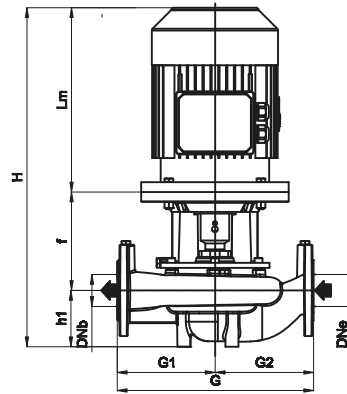

EN1092-1 PN16				
DNf	D1	De	Db	Qty.
50	165	125	18	4
50	165	125	18	4

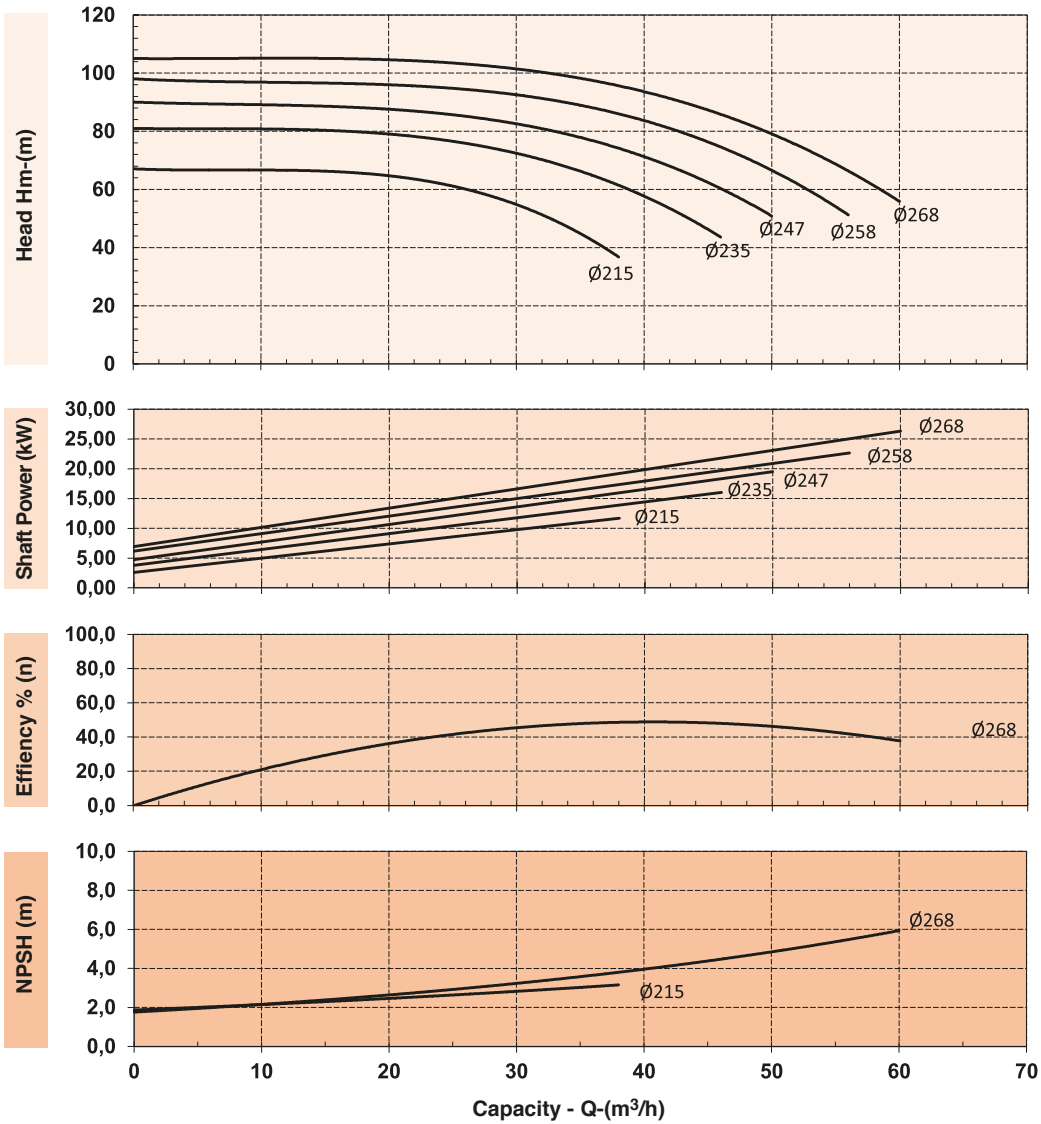

Pump Type	kW	DNb-DNe Outlet-Inlet	Dimension							Mec. Seal Diameter	Shaft and Coupling	Motor Padestal	Motor Flange	Weight (kg.)	
			Lm	G	H	G2	G1	h1	f						
TNL 50-250	11	DN 50 - DN 50	466	440	811	225	215	115	230	30	2B	A3	F5	165	
	15		466		811				230						
	18,5		519		864				230						2B
	22		519		864				230						2C



PERFORMANCE CURVES

**TNL 65-160**  
50 Hz - 2900 rpm

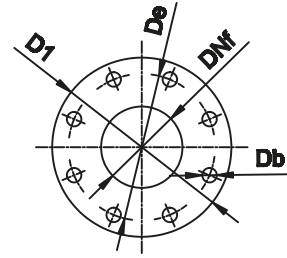
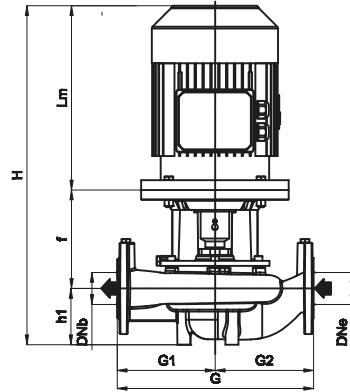

EN1092-1 PN16				
DNf	D1	De	Db	Qty.
65	185	145	18	4
65	185	145	18	4

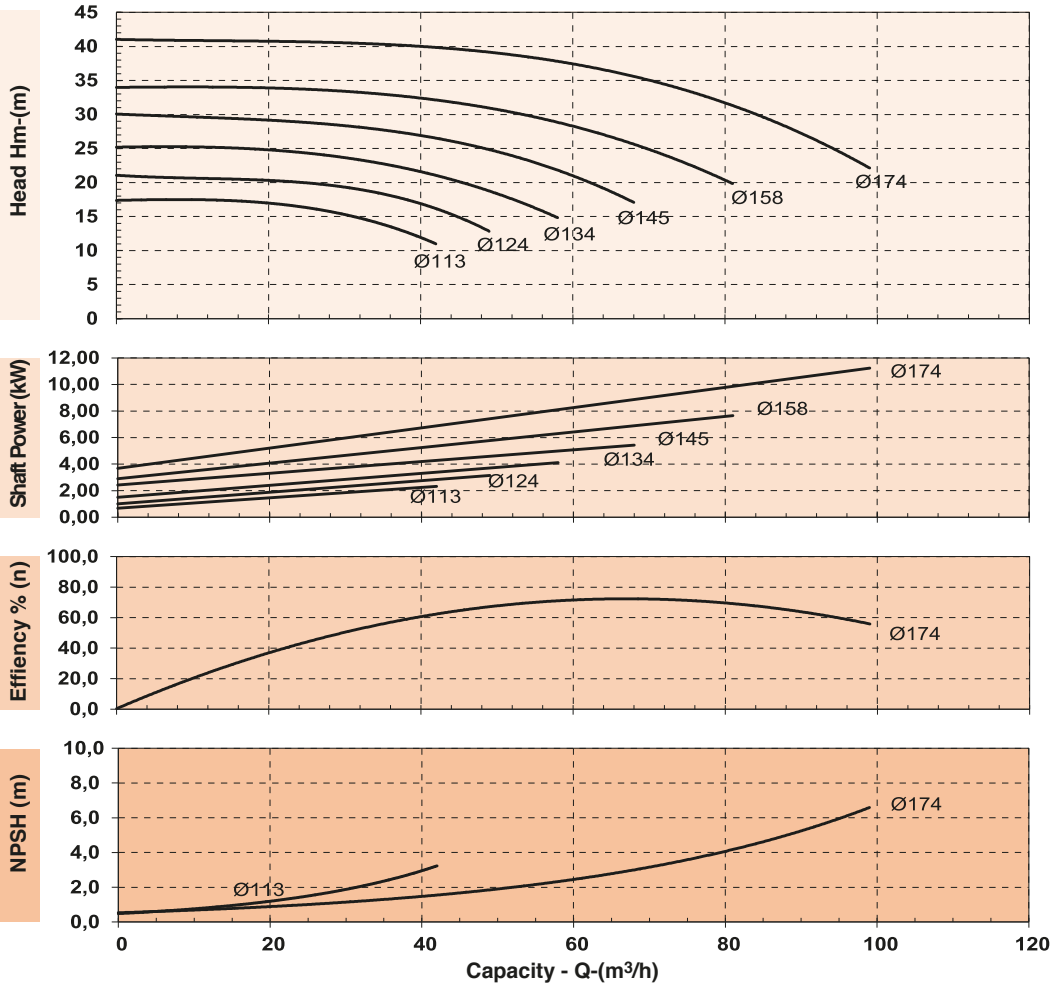

Pump Type	kW	DNb- DNc Outlet- Inlet	Dimension							Mec. Seal Diameter	Shaft and Coupling	Motor Padestal	Motor Flange	Weight (kg.)
			Lm	G	H	G2	G1	h1	f					
TNL 65-160	3	DN65- DN65	352	400	647	200	200	115	180	30	1C MİL	A1	F1	58,07
	4		395,5		670,5				180					58,9
	5,5		440,5		755,5				200					84,6
	7,5		475,5		790,5				200					85,05
	11		576		821				230					133,5



**PERFORMANCE CURVES**

**TNL 65-200**  
50 Hz - 2900 rpm

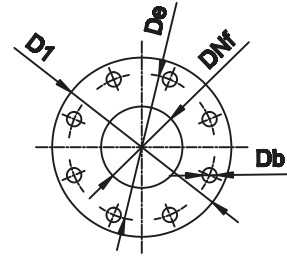
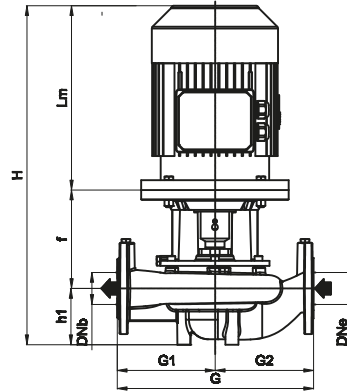

EN1092-1 PN16				
DNf	D1	De	Db	Qty.
65	185	145	18	4
65	185	145	18	4

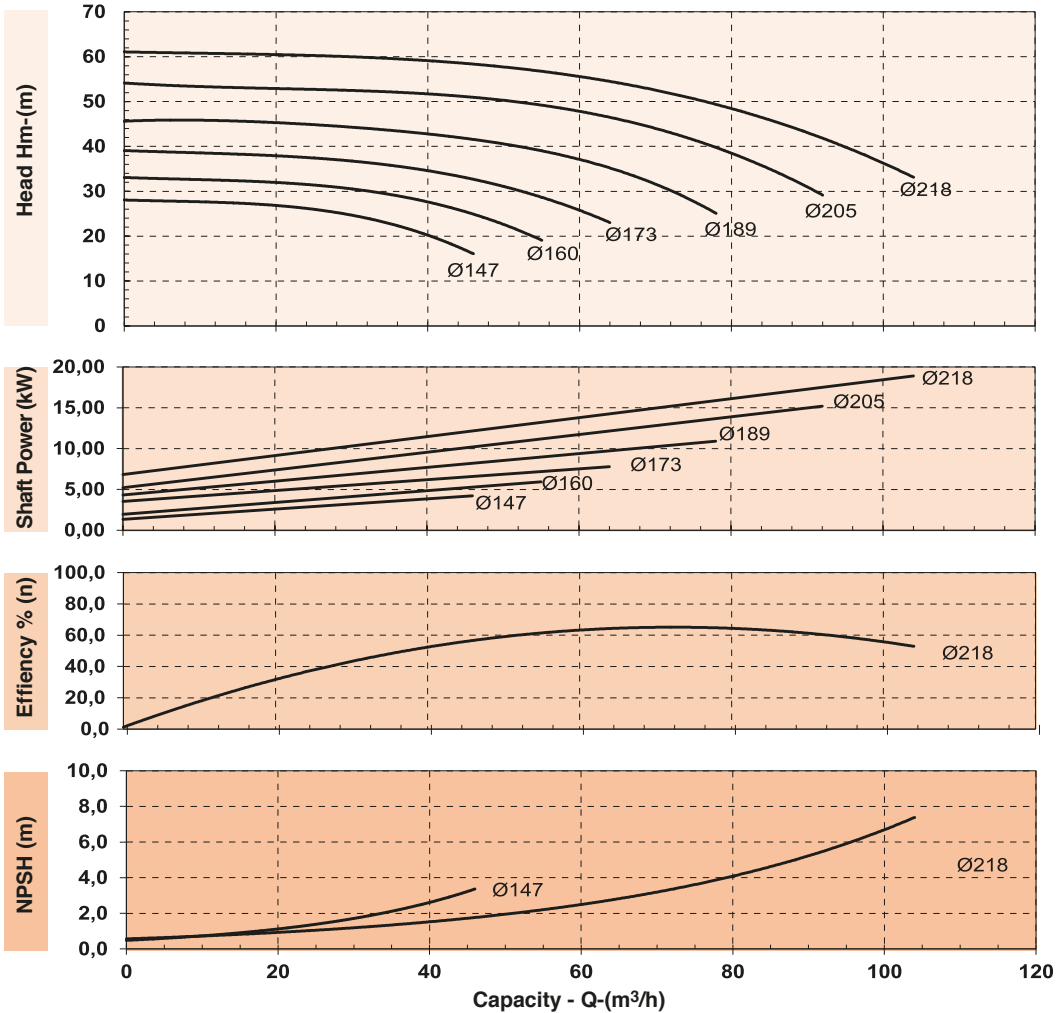

Pump Type	kW	DNb-DNe Outlet-Inlet	Dimension							Mec. Seal Diameter	Shaft and Coupling	Motor Padestal	Motor Flange	Weight (kg.)	
			Lm	G	H	G2	G1	h1	f						
TNL 65-200	7,5		475,5		795,5					205	30	2A MİL	A2	F4	95,8
	11	DN65-	576		921					230	30	2B MİL	A2	F5	142,1
	15	DN65	576	460	921	230	230	115		230	30	2B MİL	A2	F5	142,5
	18,5		576		921					230	30	2B MİL	A2	F5	142,9





## PERFORMANCE CURVES

### TNL 65-250 50 Hz - 2900 rpm

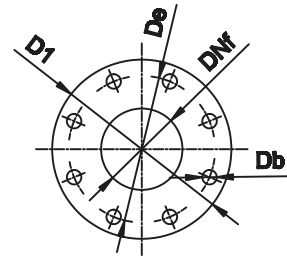
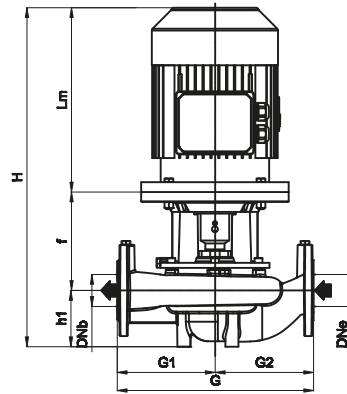

EN1092-1 PN16				
DNf	D1	De	Db	Qty.
65	185	145	18	4
65	185	145	18	4

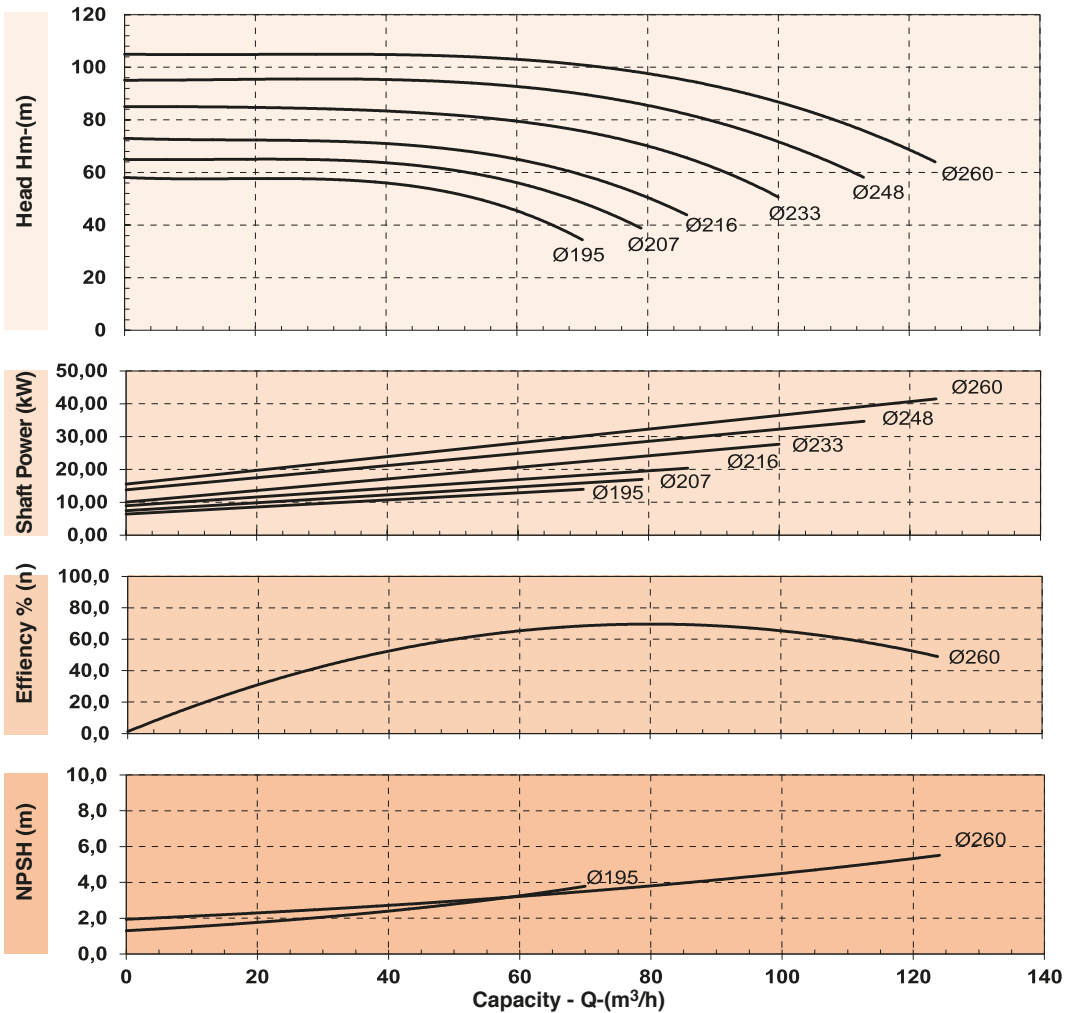

Pump Type	kW	DNb- DNe Outlet- Inlet	Dimension							Mec. Seal Diameter	Shaft and Coupling	Motor Padestal	Motor Flange	Weight (kg.)
			Lm	G	H	G2	G1	h1	f					
TNL 65- 250	15	DN 65 - DN 65	484	480	849	235	245	135	230	30	2B MIL	A3	F5	205
	18,5		528		893				230	30		A3	F5	208
	22		544		909				230	30		A3	F5	218,5
	30		637		1032				260	35		A3	F6	266
	37		637		1032				260	35		A3	F6	295
45										A3				



**PERFORMANCE CURVES**

**TNL 80-160**  
50 Hz - 2900 rpm

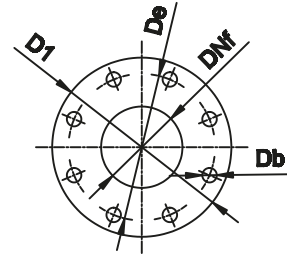
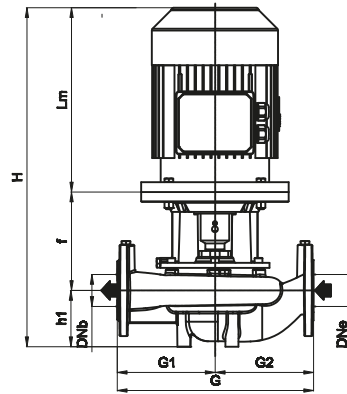

EN1092-1 PN16				
DNf	D1	De	Db	Qty.
80	200	160	18	8
80	200	110	18	8

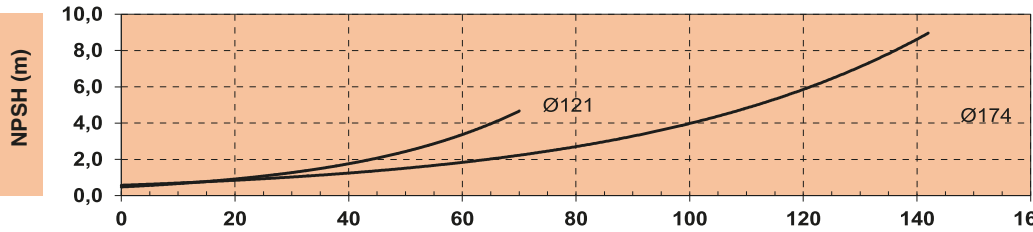
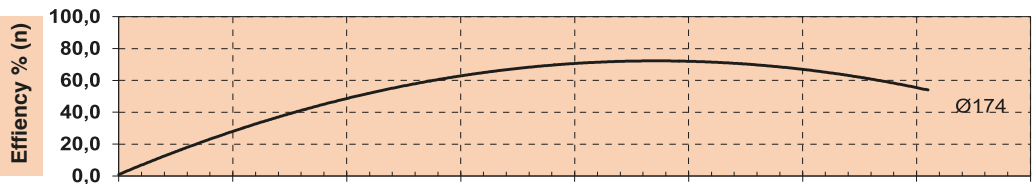
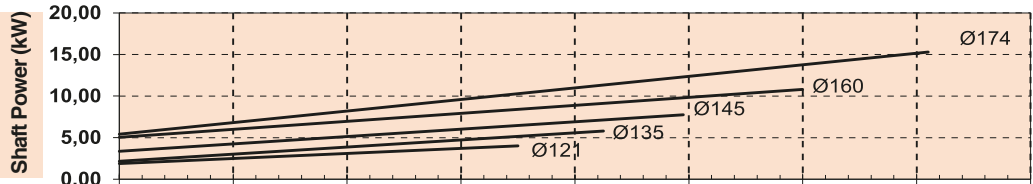
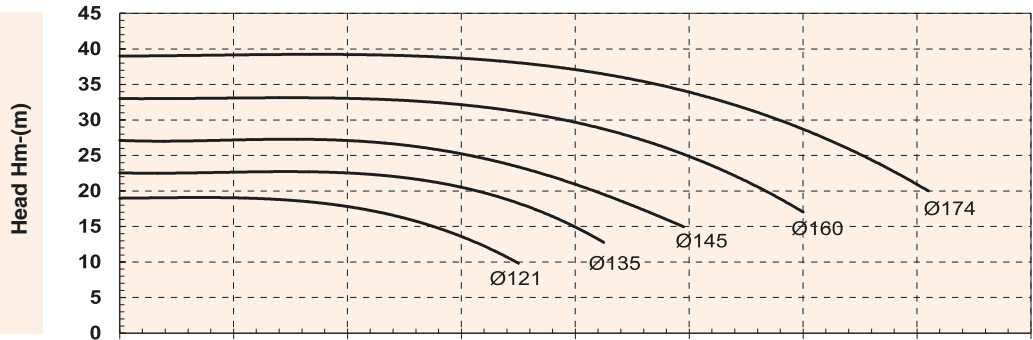

Pump Type	kW	DNb- DNc Outlet- Inlet	Dimension							Mec. Seal Diameter	Shaft and Coupling	Motor Padestal	Motor Flange	Weight (kg.)				
			Lm	G	H	G2	G1	h1	f									
TNL 80-160	4	DN80- DN80	324	440	649	220	220	135	190	20	1C MİL	A1	F1	70,8				
	5,5		440,5		785,5				210					30	2A MİL	A1	F2	89,9
	7,5		475,5		820,5				210					30	2A MİL	A1	F2	91,4
	11		576		951				240					30	2B MİL	A1.3	-	137,5
	15		576		951				240					30	2B MİL	A1.3	-	159
	18,5		576		951				240					30	2B MİL	A1.3	-	184



PERFORMANCE CURVES

**TNL 80-200**  
50 Hz - 2900 rpm

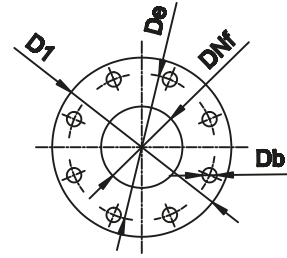
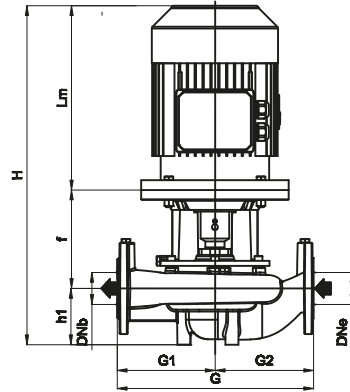

EN1092-1 PN16				
DNf	D1	De	Db	Qty.
80	200	160	18	8
80	200	160	18	8

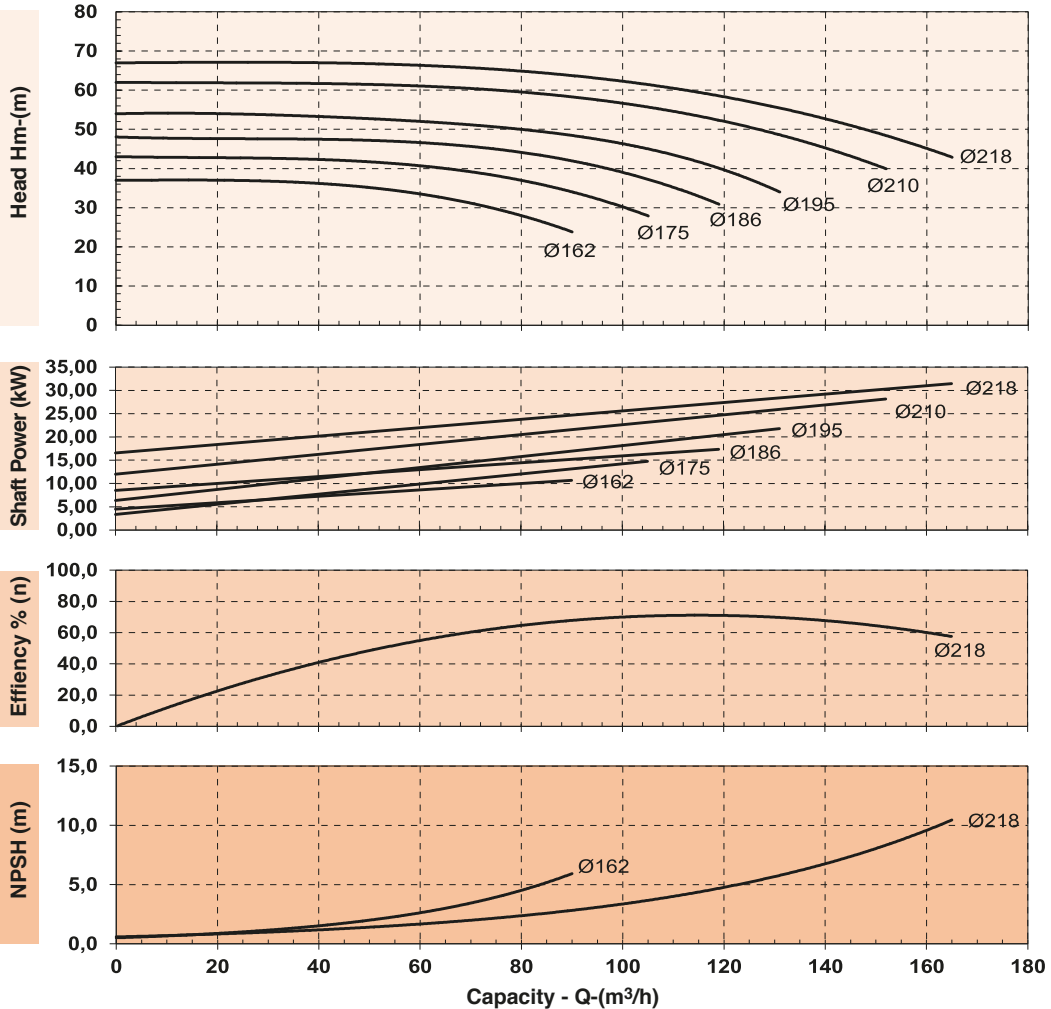

Pump Type	kW	DNb- DNc Outlet- Inlet	Dimension							Mec. Seal Diameter	Shaft and Coupling	Motor Padestal	Motor Flange	Weight (kg.)	
			Lm	G	H	G2	G1	h1	f						
TNL 80- 200	11	DN80- DN80	576	500	946	250	250	140	230	30	2B MİL	A2	F5	145,7	
	15		946		230				30					F5	146
	18,5		946		230				30					F5	146,3
	22		999		230				30					F5	179,68



**PERFORMANCE CURVES**

**TNL 80-250**  
50 Hz - 2900 rpm

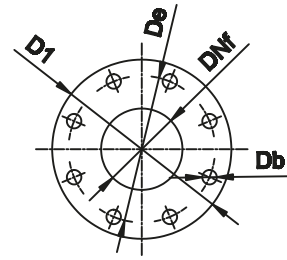
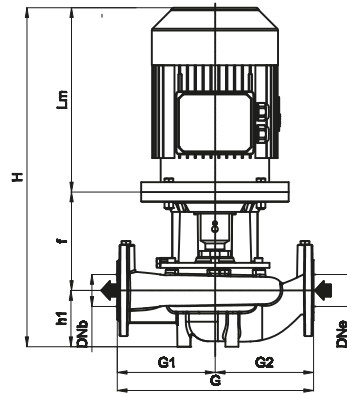

EN1092-1 PN16				
DNf	D1	De	Db	Qty.
80	200	160	18	8
80	200	160	18	8

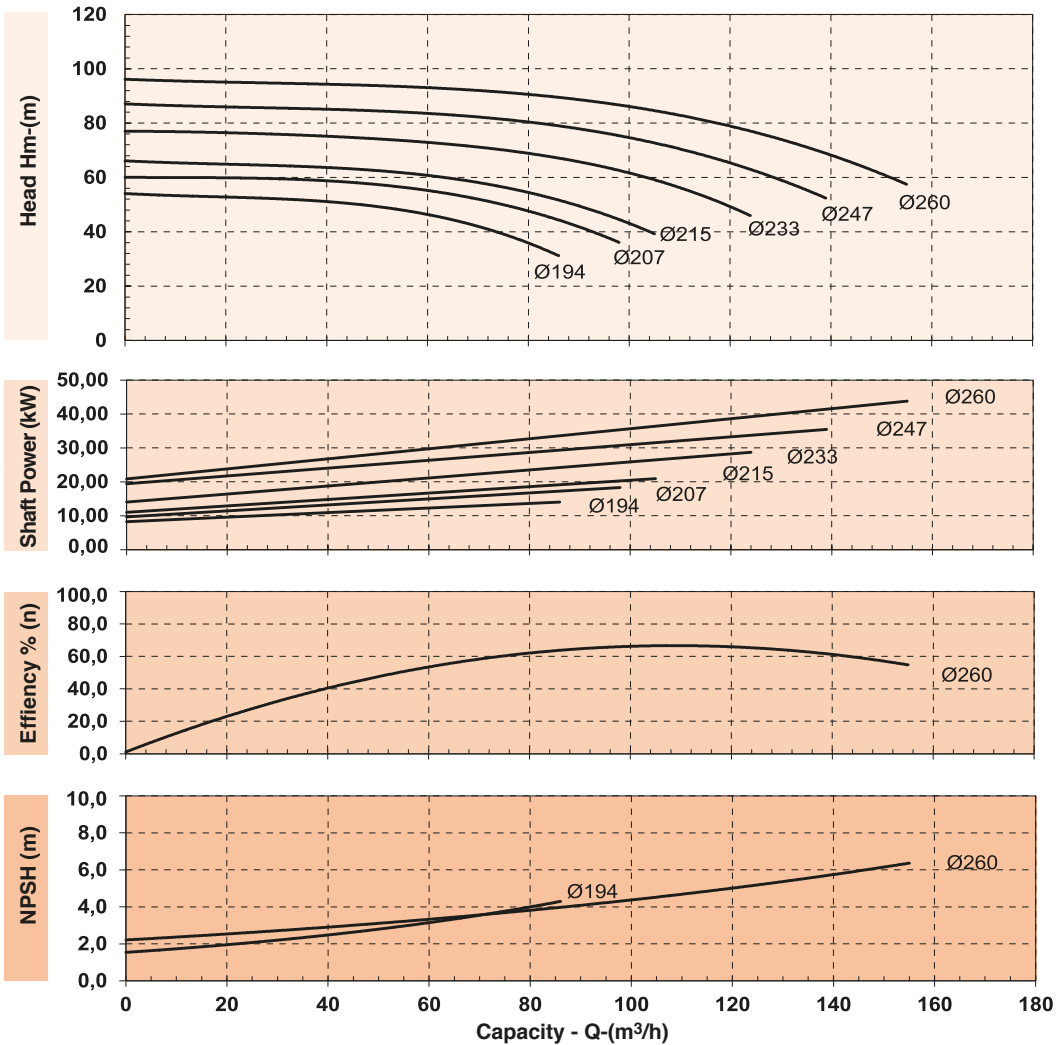

Pump Type	kW	DNb-DNe Outlet-Inlet	Dimension						Mec. Seal Diameter	Shaft and Coupling	Motor Padestal	Motor Flange	Weight (kg.)		
			Lm	G	H	G2	G1	h1						f	
TNL 80-250	15	DN80-DN80	484	550	869	280	270	145	240	30	4B MİL	B2	F7	150	
	18,5		240		30				F7			151			
	22		240		30				F7			183			
	30		637		1052				270			35	B2	F8	220
	37		637		1052				270			35	B2	F8	
	45		637		1052				270			35	B2	F8	



PERFORMANCE CURVES

**TNL 100-160**  
50 Hz - 2900 rpm

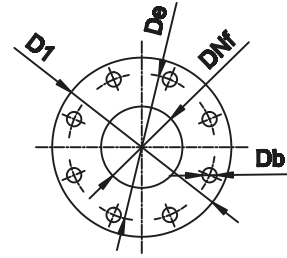
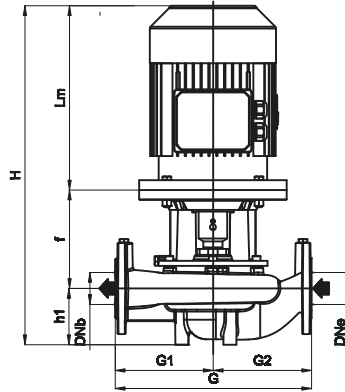

EN1092-1 PN16				
DNf	D1	De	Db	Qty.
100	220	180	18	8
100	220	180	18	8

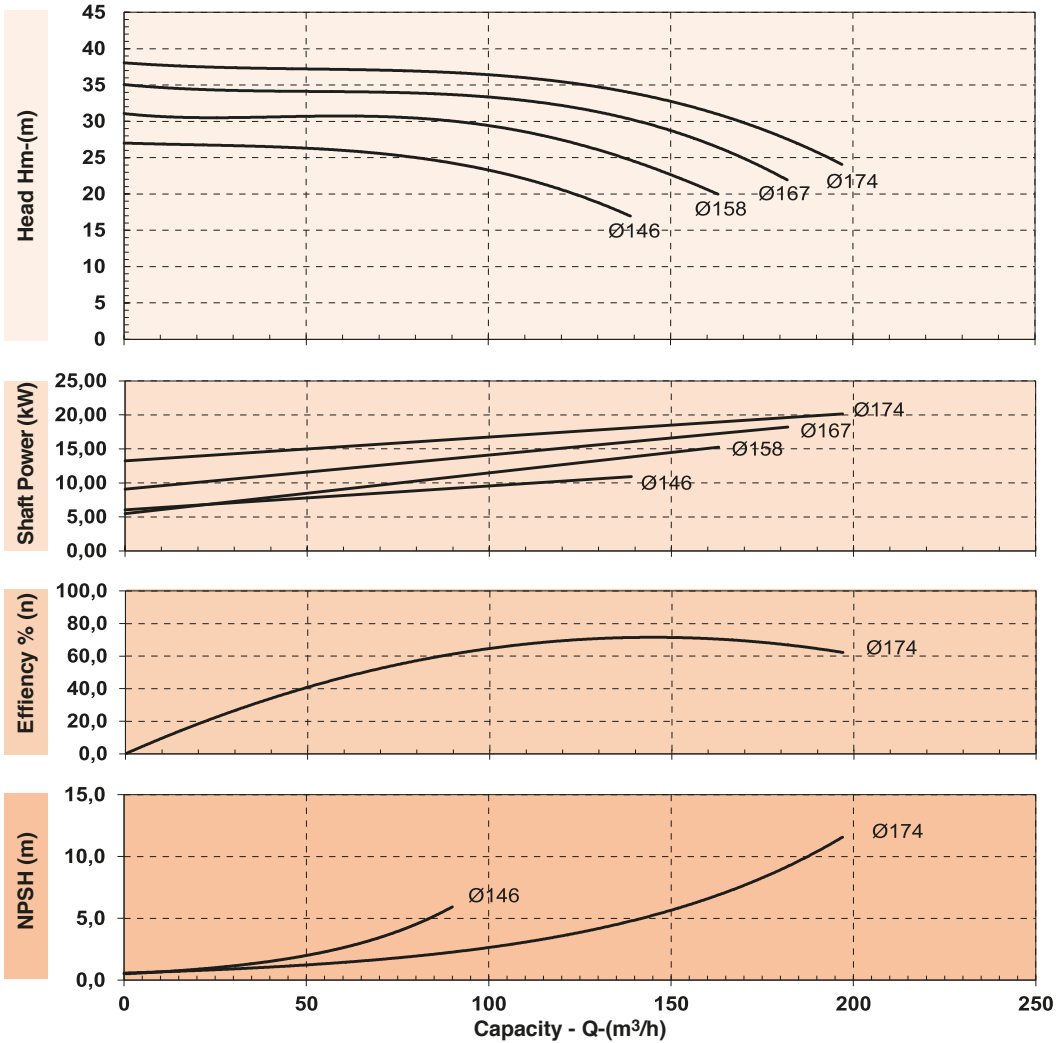

Pump Type	kW	DNb- DNe Outlet- Inlet	Dimension							Mec. Seal Diameter	Shaft and Coupling	Motor Padestal	Motor Flange	Weight (kg.)	
			Lm	G	H	G2	G1	h1	f						
TNL 100-160	7,5	DN100- DN100	375		740					240	30	2A MİL	A1	F2	100
	11		484		879				240	30	2B MİL	A1.3	-	165	
	15		484	500	879	250	250	155	240	30	2B MİL	A1.3	-	175	
	18,5		528		923				240	30	2B MİL	A1.3	-	190	
	22		544		923				240	30	2C MİL	A1.3	-	233	



**PERFORMANCE CURVES**

**TNL 100-200**  
50 Hz - 2900 rpm

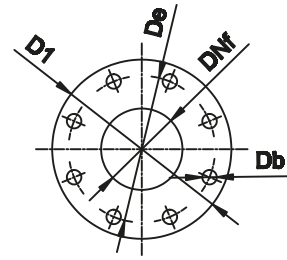
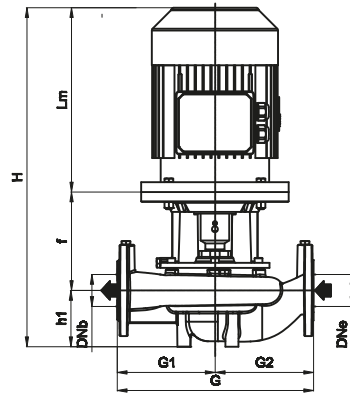

EN1092-1 PN16				
DNf	D1	De	Db	Qty.
100	220	180	18	8
100	220	180	18	8

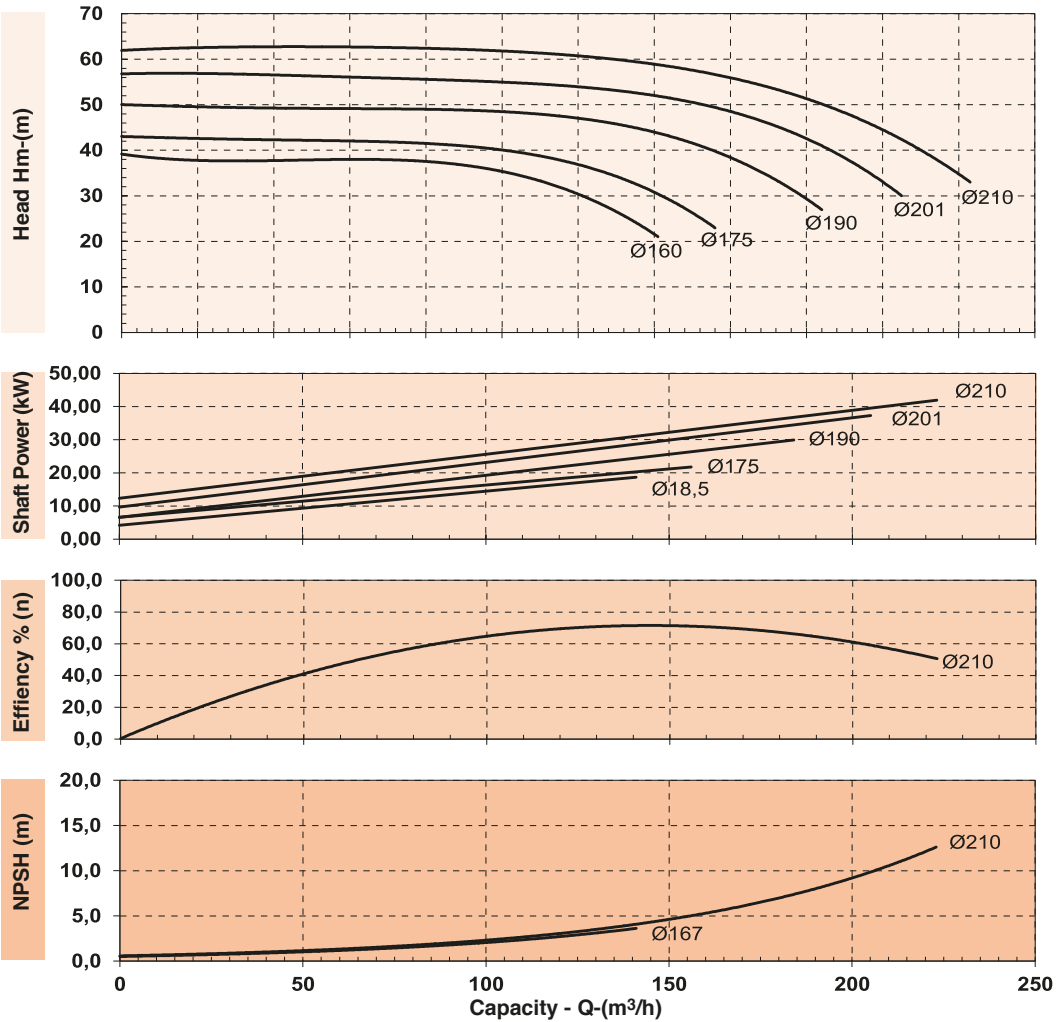

Pump Type	kW	DNb- DNe Outlet- Inlet	Dimension							Mec. Seal Diameter	Shaft and Coupling	Motor Pedestal	Motor Flange	Weight (kg.)
			Lm	G	H	G2	G1	h1	f					
TNL 100-200	22	DN100- DN100	544	550	947	275	275	180	250	30	4C MIL	B1	F5	246
	30		280		35									
	37		280		35									
	45C		280		35									

